

شركة مصنع الصفوف الوطنية ذ.م.م  
AL-SOFOUF AL WATANIYA FACTORY CO.



صناعة وطنية ..  
بمعايير عالمية



[www.rfufco.com.sa](http://www.rfufco.com.sa)  
RFUFCO

Head Office: Riyadh - Second Industrial City  
P.O.Box 147 - Riyadh 11383 K.S.A.  
Tel: + 966 11 2651444 Fax: + 966 11 2652416

المركز الرئيسي: الرياض - المدينة الصناعية الثانية  
ص.ب: 147 - الرياض 11383 المملكة العربية السعودية  
هاتف: + 966 11 2651444 فاكس: + 966 11 2652416



**National industry ..**  
international standards

شركة مصنع الصفوف الوطنية ذ.م.م  
AL-SOFOUF AL WATANIYA FACTORY CO.



صناعة وطنية ..  
بمعايير عالمية



[www.rfufco.com.sa](http://www.rfufco.com.sa)



RFUFCO

Head Office: Riyadh - Second Industrial City  
P.O.Box 147 - Riyadh 11383 K.S.A.  
Tel: + 966 11 2651444 Fax: + 966 11 2652416

المركز الرئيسي: الرياض - المدينة الصناعية الثانية  
ص.ب: 147 - الرياض 11383 المملكة العربية السعودية  
هاتف: + 966 11 2651444 فاكس: + 966 11 2652416



**National industry ..**  
international standards

شركة مصنع الصفوف الوطنية ذ.م.م  
AL-SOFOUF AL WATANIYA FACTORY CO.



صناعة وطنية ..  
بمعايير عالمية



[www.rfufco.com.sa](http://www.rfufco.com.sa)



RFUFCO

Head Office: Riyadh - Second Industrial City  
P.O.Box 147 - Riyadh 11383 K.S.A.  
Tel: + 966 11 2651444 Fax: + 966 11 2652416

المركز الرئيسي: الرياض - المدينة الصناعية الثانية  
ص.ب: 147 - الرياض 11383 المملكة العربية السعودية  
هاتف: + 966 11 2651444 فاكس: + 966 11 2652416



**National industry ..**  
international standards



## **Founded Plant**

*The National shelves factory " RFUFCO COMPANY " was founded in 2000. Its activity is based on metal shelves that provided that needs of processing by shelves with its different commercial and governmental with global quality.*

*Since the Establishment of the company our aim is the sincerity and honesty in dealing with our respected customers, this what always makes us an the best choice to provide your request.*

*This the ideal choice, which we got it from the big companies and goverment department excited us to develop of production lines through our factory which is located in the Second Industrial City - Riyadh. Our factory is equipped with the latest technologies through adopting on the automation of the machines ( Roll Forming ) and robotic machines. These machines ensure not to include any manufacturing flaw in the product.*

*Things that makes us pioneers in processing warehouse and shops that we provide professional team, all equipment and the accessories for installation the work in a way that we can provide the different needs our valued customers.*



Showroom 1 - Alkazan street, Riyadh Branch



Showroom 2 - Exit 16, Riyadh Branch



Showroom 3 - Jeddah Branch



Showroom 4 - Al Qasim, Buraidah Branch

## Our Factory

### Our Vision:

To be the pioneers in finding the best solutions for storage and display system in warehouse and shops around the arabic world.

### Values:

**Quality:** producing with high precision and professionalism without any production flaw..

**Credebility:** We fulfill our promisses in applying for our valued.

**Customers:** Focusing on customers, our clients are our partners in the success

**Innovation:** Continuous developing for our products and motivate our employees to be creative.

### Our Mission:

Rfufco Company creates the best solutions for storage and display system in warehouse and shops for our valued partners in the success of the government and private companies and institutions in Saudi Arabia and the Arab market based on our experience and our professional, qualified and trained staff using the latest machinery production lines.

According to the highest quality and the requirements of the global storage standards to provide the aspiration of our valued customers.



# Contents

1-4.....Advance Machines



Company References.....4-8

Quality Certification



Selective Pallet Rack

Drive-In Rack Storage



Mezzanine Floor

Very Narrow Aisle ( VNA )



Double Deep Pallet Rack

Light Duty Rack



Radio-shuttle Storage

Cantilever Storage



Bolts Free

Stationary Steel Drawer



Supermarket Shelvings

Promotional Stand



Rack Accessories

Pallets Rack



Some of Finish Project

# PALLET STORAGE SOLUTIONS



Double Deep Pallet Rack



Selective Pallet Rack



Narrow Aisle Rack ( VNA )



Drive-In Pallet Rack



Radio-Shuttle Pallet Rack



AS / RS Pallet Storage

# BUSSINESS STORAGE SOLUTIONS



Mezzanine Storage



Light Duty Rack Storage

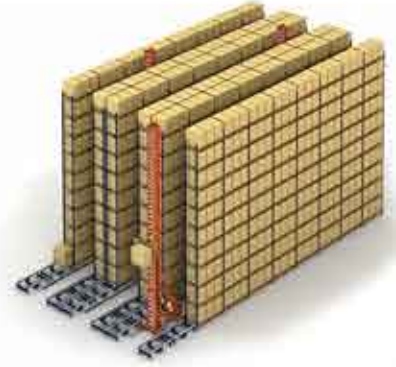

High Rise Archive Storage



Office Archive Box Storage



Mobile Archive Storage



Open File Archive Storage

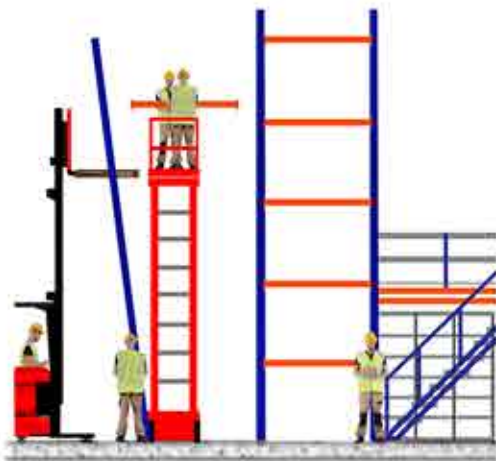

Accredited Installation



Audits, Service and Repairs



## Advance Machines



*High quality products by our new advance machine technology dedicated to modern market.*

*Strictly control in inspection.*

*Quality assurance system is divided into every single detail, with control being performed. all the way.*

*Strictly control in raw material.*

*Raw material for all products are of good quality and advanced performance, and those for main parts must pass quality inspection before use, so as to lay a solid foundation for protect quality assurance.*

*Strictly control in production process.*

*Strict inspection on product quality is throughout the whole process, with each process step requiring self-check and every two sequential process steps requiring mutual-check, to achieve an overall control on new products.*

Some of Our Rerferences

Quality Certificate ( TUV )

ZERTIFIKAT ♦ CERTIFICATE ♦ CERTIFICADO ♦ CERTIFICAT ZERTIFIKAT ♦ CERTIFICATE ♦ CERTIFICADO ♦ CERTIFICAT		<b>FAHSS/TÜV NORD Saudi Arabia</b> <b>INSPECTION CERTIFICATE OF ASSESSMENT</b>	
	<b>AL SOFOUF ALWATANIYA FACTORY CO. (RFUFCO)</b>		<b>NO. 201728</b>
	P.O.Box:147, Riyadh 11363 Kingdom of Saudi Arabia		
	WAS TECHNICALLY TESTED AND ASSESSED OF THEIR PRODUCT MANUFACTURING of <b>HEAVY DUTY PALLET RACKING STORAGE SYSTEM</b> <b>LIGHT DUTY SHELF STORAGE SYSTEM</b> <b>DRIVE-IN PALLET RACKING SYSTEM</b> <b>MEZZANINE FLOOR STORAGE</b> and <b>BOLT FREE SHELVEING'S</b> WITH A MATERIAL SPECS: JIS G31331 SPHC, SPHD Steel Plate <b>DESIGNED AND MANUFACTURED BY AL SOFOUF ALWATANIYA FACTORY CO. ( RFUFCO)</b>		
	CONFORMS TO THE REQUIREMENTS OF THE STANDARD <b>EN 15512: 2009</b> also S.E.M.A. " Code of practice for the design of static racking"		
	For the specified product specification, mentioned above has been assessed inspect and tested in according to company product specification; Company comply the procedure and specification as per Rack Manufacturing Institute As far as ascertainable this product complied with the applied standards and void of principal defects that can affect the condition. No restrictions for further safe condition.		
	Recommendation: Follow the safe working value specified on its company product code.		
	DATE OF INSPECTION    21-09-2016	DATE NEXT INSPECTION    20-Sep-17	
	ADDITIONAL SUPPORTING DOCUMENTS :		
	AUTHORISED INSPECTOR: AQEEL AL-DARWISH	INSPECTOR: HERMIE B. OERESMA	
WARNING: (1) This certificate should not be altered or defaced in any way or it will render the Certificate invalid. (2) This Certificate is not valid unless authenticated by the FAHSS / Inspection Stamp and Inspector's Signatures.		SIGNATURE:  STAMP: 	
NATIONAL INSPECTION AND TECHNICAL TESTING CO. LTD. (FAHSS / TÜV NORD SAUDI ARABIA) P.O BOX 10771 JUBAIL 31961 JUBAIL: Tel: (013) 340 7607 / 7608 / 7609. Fax: (013) 340 7609    JEDDAH: Tel: (012) 652 0212 / 814 3435-Fax: (012) 462 0622 YAMBU: Tel/Fax: (014) 325 1475    RIYADH: Tel: (011) 473 3904 (direct)- Fax: (011) 292 0939			
EMAIL: info@fahsstuv.com		FM-IN-122A REV 03.12/02/12	

Quality Products Certificate



Beam Actual Testing



Upright Actual Testing

## Powder Coating Certificate



*Powder Coating machine*



## Upright Specification

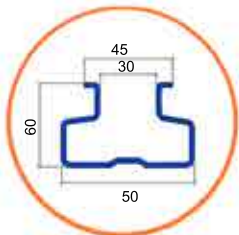
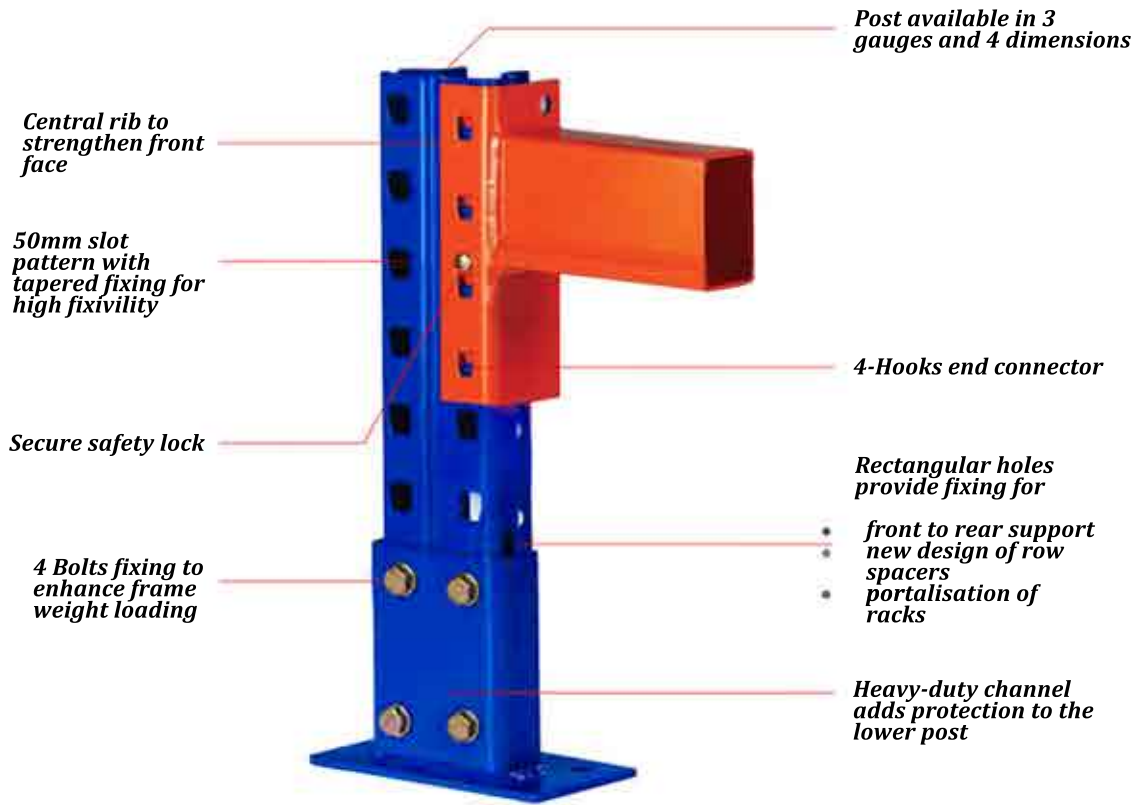

RFU 50

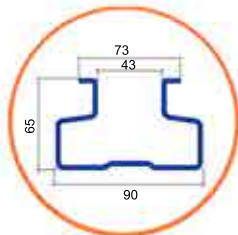

RFU 90

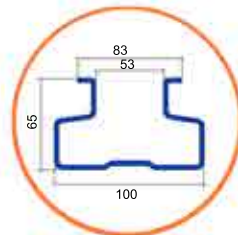

RFU 100

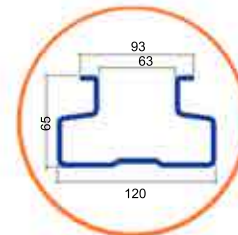

RFU 120



RFU 50



RFU 90



RFU 100



RFU 120

## Upright Specification

### Frame ( Upright )

Vertical elements created by two uprights joined together with cross ties. Side panels of set cross ties and diagonal providing the necessary rigidity.

- The basic frame made up of two uprights cross ties and footplates
- The number of cross ties depends basically on the height of frame.
- The minimum number used is two
- The most common frame height are:  
1.5 m, 2 m, 3m and 4m they can manufactured up to 10m

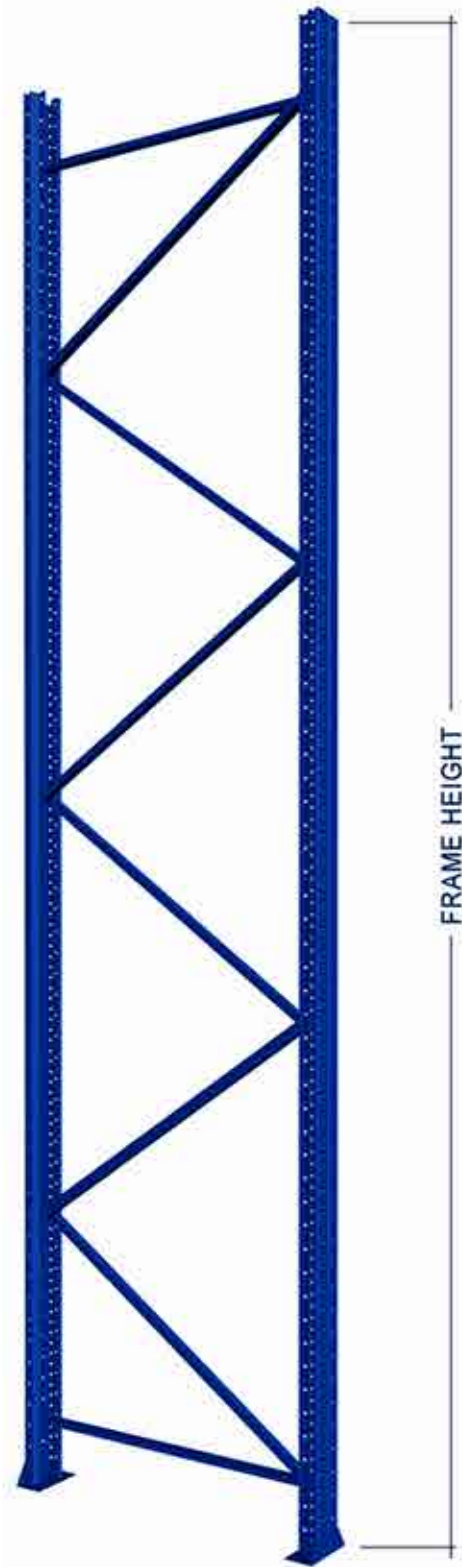

### Frame cross ties

the cross ties slid down inside the upright until the fixing points is reached, making the set extremely rigid.  
at least two are fitted, depending on the height of the frame. The uprights can be manufactured in the heights of up to 10m.



### Foot plates

Suitable for heavy load, as they distribute the weight over the floor.

L-Type Footing

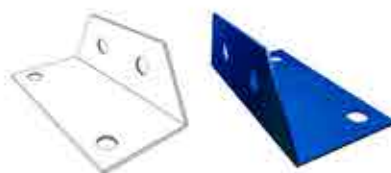

U-Type Footing

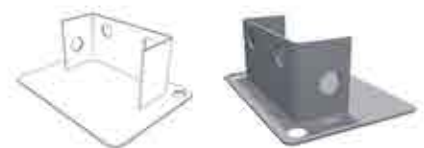









## Beam Specification

**Beams** are available designs, These Roll Forming beams come in varying sizes and gauges to accommodate different weight load requirements. Interlock beams are supplied in a standard 'Alert' Orange. Other non-standard 'house' colours can be offered, subject to volume and colour availability

### BEAM SECTION

					
<b>BEAM SECTION</b>	-60x30x1.2 -60x30x1.5 -2 or 3 hooks connector	-80x50x1.2 -3 hooks connector	-100x50x1.2 -3 hooks connector	-120x50x1.2 -3 hooks connector	-150x50x1.2 -4 hooks connector

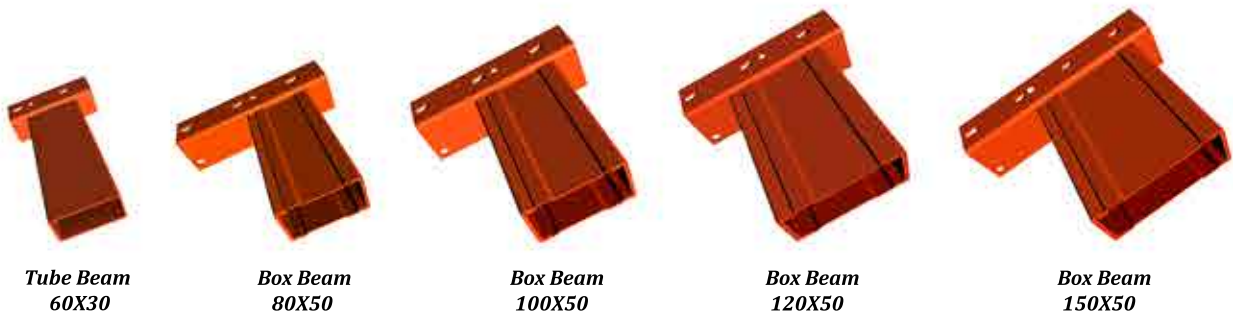

### BEAM LOADING CAPACITY

BEAM	1500mm	1800mm	2000mm	2300mm	2500mm	2700mm	3000mm	3300mm
60x30x1.5	700kg	600kg	500kg	450kg	400kg	-----	-----	-----
80x50x1.5	3290kg	2410kg	2030kg	1630kg	1450kg	1300kg	1050kg	950kg
100x50x1.5	5280kg	3740kg	3080kg	2380kg	2050kg	1800kg	1450kg	1350kg
120x50x1.5	5256kg	5700kg	4640kg	3510kg	2970kg	2550kg	2060kg	1960kg
150x50x1.5	9648kg	6700kg	5430kg	4100kg	3470kg	2980kg	2410kg	2310kg

# *Automation Racking (AS/RS)*



## Automation Racking AS/RS

### Automation Racking AS/RS

Automated warehouse racking storage system that integrate shelving, machinery and warehouse management software all in one. It is made up of a central aisle, along which a stacker crane travels, and two racks built at either side used to store boxes or trays. the picking and handling area is formed by conveyors and is positioned at one end or at the side of the racking. Here, the stacker crane deposits the load extracted from the rack. The conveyors then take the box to the operator and once he/she has finished the job, it is returned to the stacker crane which then places it back in the racking. The whole system is controlled by a management software which registers the location of all the materials in the warehouse and keeps a real time inventory.

#### Advantage:

1. Applies " product to operator " principle.
2. Automation of the entry and exit operation of the products.
3. Permanent inventory.
4. Eliminating the errors arising from the manual management.
5. Optimal use of available space.
6. Maximum comfort and easy access to the stored boxes.



## Automation Racking AS/RS



*Automated storage and retrieval systems, usually referred to as AS/RS system are computer controlled systems for storing and retrieving products in warehouses. These AS/RS system required the use of virtually no manual labor.*

*Unit-load AS/RS are bigger system that typically store pallet loads. Smaller systems which are commonly called mini-load AS/RS allow selection of items in totes, trays, or cartons. AS/RS system are configured with pallet rack laid out with narrow aisles between. A crane with a tall mast travels through the aisle and moves vertically and horizontally to storage picking positions. When the AS/RS system crane reaches the storage location a carriage travels up the mast to the picking spot. An automatic mechanism then reaches into the storage location to retrieve or return in the pallet load.*

*The unit load AS/RS systems are designed for larger loads which are pallets or pallet-sized loads. system are over 100 feet tall. Whatever the application. RFUFCO COMPANY system engineering can an AS/RS application to maximized pallet storage.*

*The benefits of a fixed aisle system such as AS/RS are decreased space required and the reduced labor needed to store and retrieve materials efficiently. AS/RS system can also installed in harsh environments that can create hazardous conditions for workers such as freezers. Because of the computer involved AS/RS can create a very accurate form of inventory control with only a few employees on site.*

## Automation Racking AS/RS

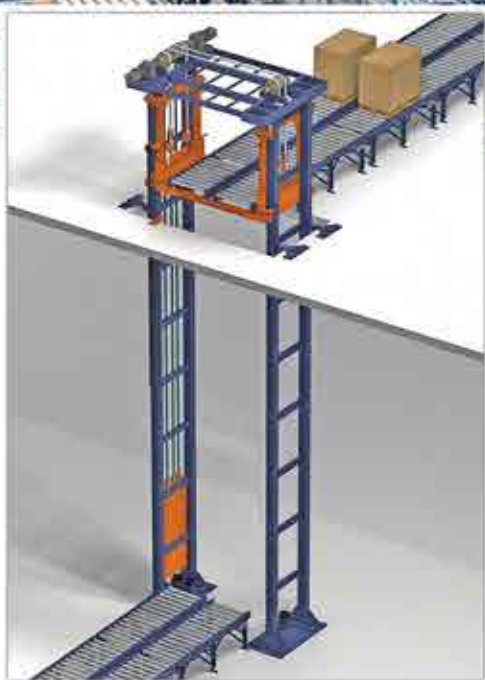

*They are machines designed for the automated storage of materials. they travel along the aisle of the warehouse, where they enter position and extract materials. The stacker cranes are guided by a management software system, which coordinates all the activities. the range of stacker cranes adapts easily to the needs of each warehouse in terms of loads capacity, dimensions, building height and cycle times and so is able to cover a huge range of applications.*

*Automation Racking AS/RS*



## Automation Racking AS/RS



### **Automation Racking AS/RS**

*Automatic trilateral stacker cranes make it very easy to automate warehouses with conventional racks where a man operated elevator truck is used, both in pre-existing warehouses and new facilities.*

*The stacker cranes moves pallets to the extremes of passageway leaving the load on the rack or automatic transport system. this is possible since it has the rotating head enabling you to pick-up and leave pallets in three positions: one frontal and two lateral.*

# *Conveyor System*





## Conveyor System



*Automated transport of boxes follows very similar criteria to those for pallets and is developed to work with plastic and cardboard boxes. the most common tranfort modules is the order conveyor, in all its different variations straight, curved, diversion and injection modules, etc. complemented by band and belt conveyors, as well as lifts and inclined conveyors to overcome changes in height.*



Conveyor System



## Conveyor System



*A conveyor system is a common piece of mechanical handling equipment that moves materials from one location to another. According to sclater, conveyor system can be divided into two classes: those that are part of a machine for processing product, and those that move products in various stages of fabrication.*



Conveyor System



# *Selective Pallet Rack*

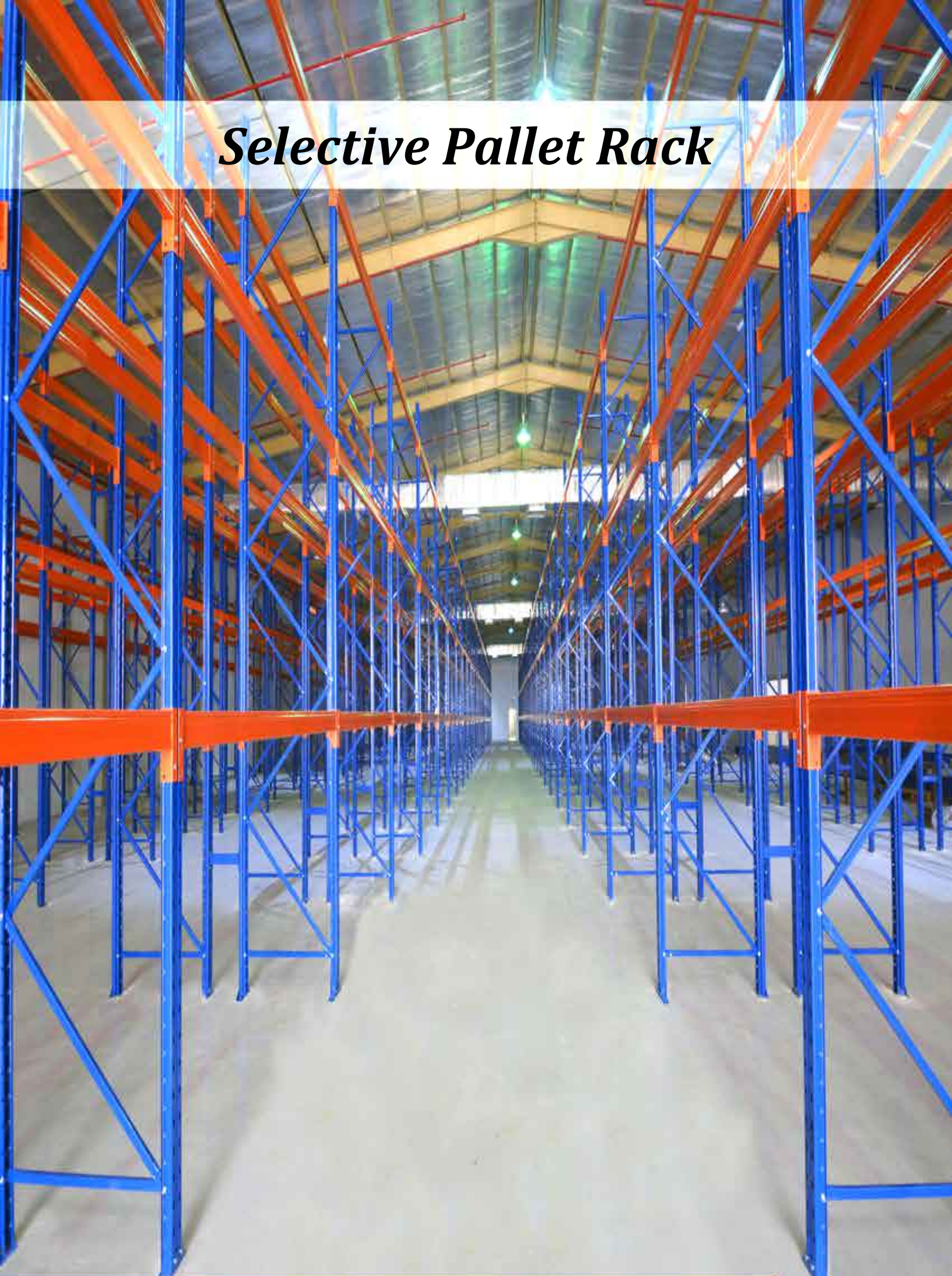

## Selective Pallet Rack



### Facts about Selective Interlock System

- **Good Stock Rotation**
- **Good Order picking; 100% selectivity**
- **Average Picking rate**
- **Good product protection**
- **Low Floor area utilization -30% net pallet area usage of overall warehouse area.**
- **Limited pallet redundancy as the system can run at 95+% capacity with a competent**
- **Warehouse Management System ( WMS )**
- **Popular application in most industries requiring instant accessibility of all pallets.**
- **Mechanical Handling Equipment**
  1. Walk behind or ride on stackers
  2. Counter Balance / Reach Trucks
  3. Reach Truck offers up to 30% improved use of floor space and operates to height in excess of 11+m high



## Selective Pallet Rack



*Rfufco selective pallet racking system offers that best solution for warehouses where a wide range of references need to be stored on pallets*



- A **selective pallet** racking warehouse is generally laid out with single-entry racks either side and double entry-racks in the middle. The width of the working aisle between each rack and the height of the racks depends on the characteristics of the forklifts or handling equipments. The size of the pallets and the height of the warehouse itself
- Goods can be easily retrieved as each pallet can be accessed without the needs to shift other pallets.
- Total stock control: each storage space is taken up by a single pallet.
- Maximum adaptability to any load type both in terms of weight and volume.

## Selective Pallet Rack



The above image shows a pallet racking warehouse with pallets which are handled by the side measuring 1200mm.



Wooden Pallet



Plastic Pallet



## Selective Pallet Rack

### Double deep conventional racking

In order to store greater number of pallet ( depending on their weight or number of pallets per reference ) double-deep racks can be installed, enabling one pallet to be stored in front of another on each side of the aisle.

Since direct access is only available for the front pallets, this system is recommended for products with more than one pallet per reference

This system requires suitable lifting machinery fitted with double-depth telescopic forks.



## Selective Pallet Rack

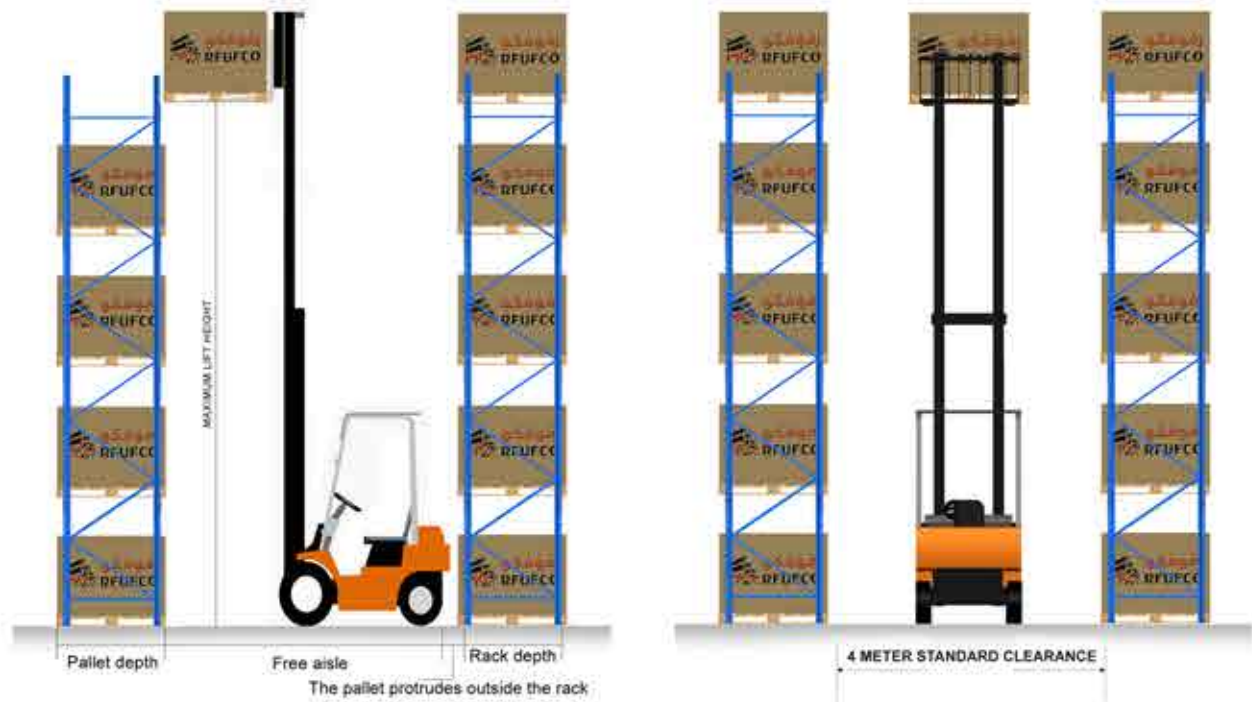

### Reach height and clearance

The height between loads levels is obtained by taking into account the total height of the pallets plus the load and adding this figure to the necessary clearance. This should be less than the figure indicated in the technical rack.

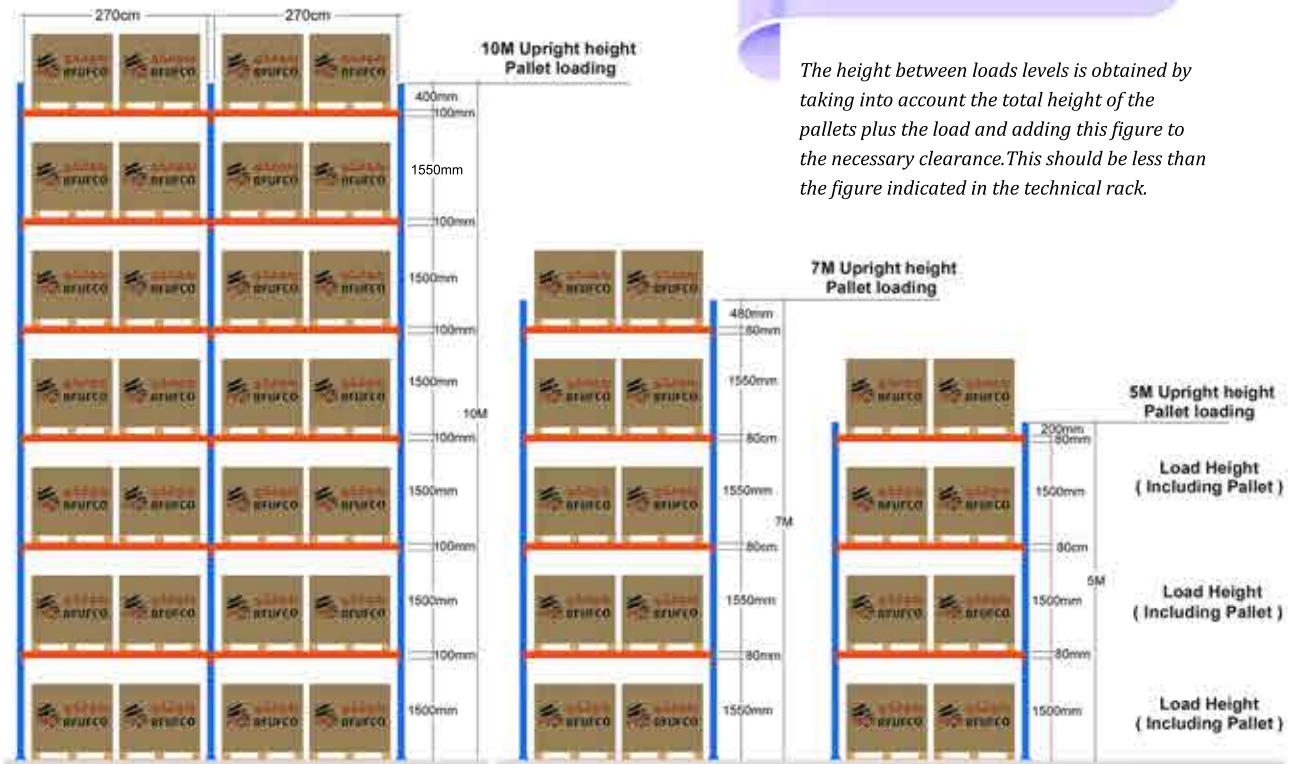

## Selective Pallet Upright

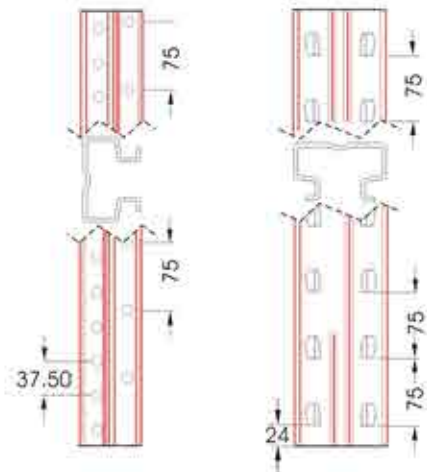

### Upright

Frames are made up of two uprights with the corresponding horizontal and diagonal bracing. Footplates and accessories, they are slotted every 50mm in order to fit the beams.

The depth of the frame is determined by the size of the pallet. For a europallet measuring 1,200 mm deep, a 1,100mm from is normally.

### Upright section

The different models, sections and thicknesses of upright enable them to be adapted to a wide range of loading requirements

Upright 50	Upright 90	Upright 100	Upright 120	Upright Support
Section : 50X60 Thickness: 1.5, 1.8mm	Section : 90X65 Thickness: 1.5, 1.8, 2.0mm	Section : 100X65 Thickness: 1.5, 1.8, 2.0mm	Section : 120X65 Thickness: 1.5, 1.8, 2.0mm	Section : 30X30 Thickness: 1.5, 2.0mm



Upright 50



Upright 90



Upright 100



Upright 120



Upright Support

## Selective Pallet Support



Rack Double Unit

### Frame Spacer or Upright Cross Support

Use connect frames & frame ( double side ) of frames and upright  
 Length as required  
 Size: The body tubular 25x25 with Fixing Double Sides, 2Pcs. M10x15 Bolts & nuts at endplates, 1Pcs. N10x65 / 110 Bolt & nuts at the other ends.



### Row Spacer or Joint

Use Row Spacers are fitted between frames of double entry racks to increase front to back rigidity and stability.  
 Length as required.  
 Size; 40x40x1mm Tubular with 2mm Endplates  
 30x60x1mm Tubular with 2mm Endplates  
 Fixing; Tow N10x25mm Grade 8.8G set crews.



### Footplates

Frame are erected on the floor using footplates which are fitted to the base of the upright. There is a range different frame footplates whose used depends on the load to be supported and on the upright model used. they are anchored to the floor using one or two anchor bolts.



U-Type Footing

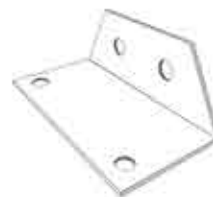







L-Type Footing



## Selective Pallet Beams

Beams are the horizontal and robust component of the rack upon which load arfe deposited. they are joined to the upright via connectors or endplates, which fit into the slots of the upright. The hooks on these endplate, in the connecting system designed and patented by **RFUFCO**, are joined to the main body of both end. the considerably increase load capacity and prevents deformation that typically occur when the connection between the main body and the hooks or endplate is not sturdy enough.



BEAM SECTION					
					
<b>BEAM SECTION</b>	-60x30x1.2 -60x30x1.5 -2 Lips connector	-80x30x1.2 -3 Lips connector	-100x50x1.2 -3 hooks connector	-120x50x1.2 -3 hooks connector	-150x50x1.2 -4 Lips connector



Tube Beam  
60x30



Tube Beam  
80x50



Tube Beam  
100x50



Tube Beam  
120x50



Tube Beam  
150x50

### End Connector Types

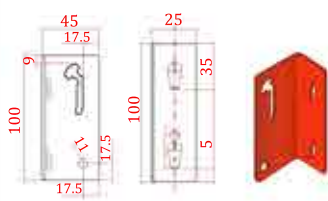
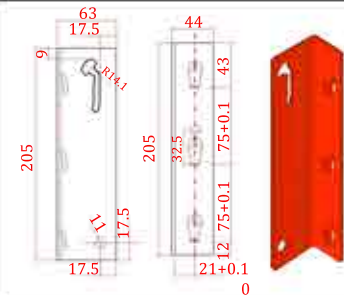
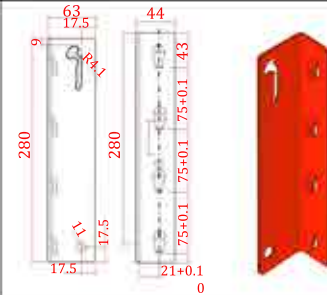
2-Hooks End Connector - 3mm	3-Hooks End Connector - 4mm	4-Hooks End Connector - 4mm
		

### Safety Locking Pin

The end plate that joins the beam and upright include the built-in safety locking mechanism developed in order to make the structure even safer.

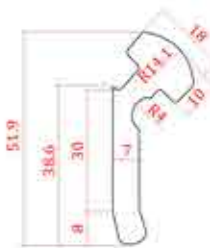

## Selective Pallet Shelves

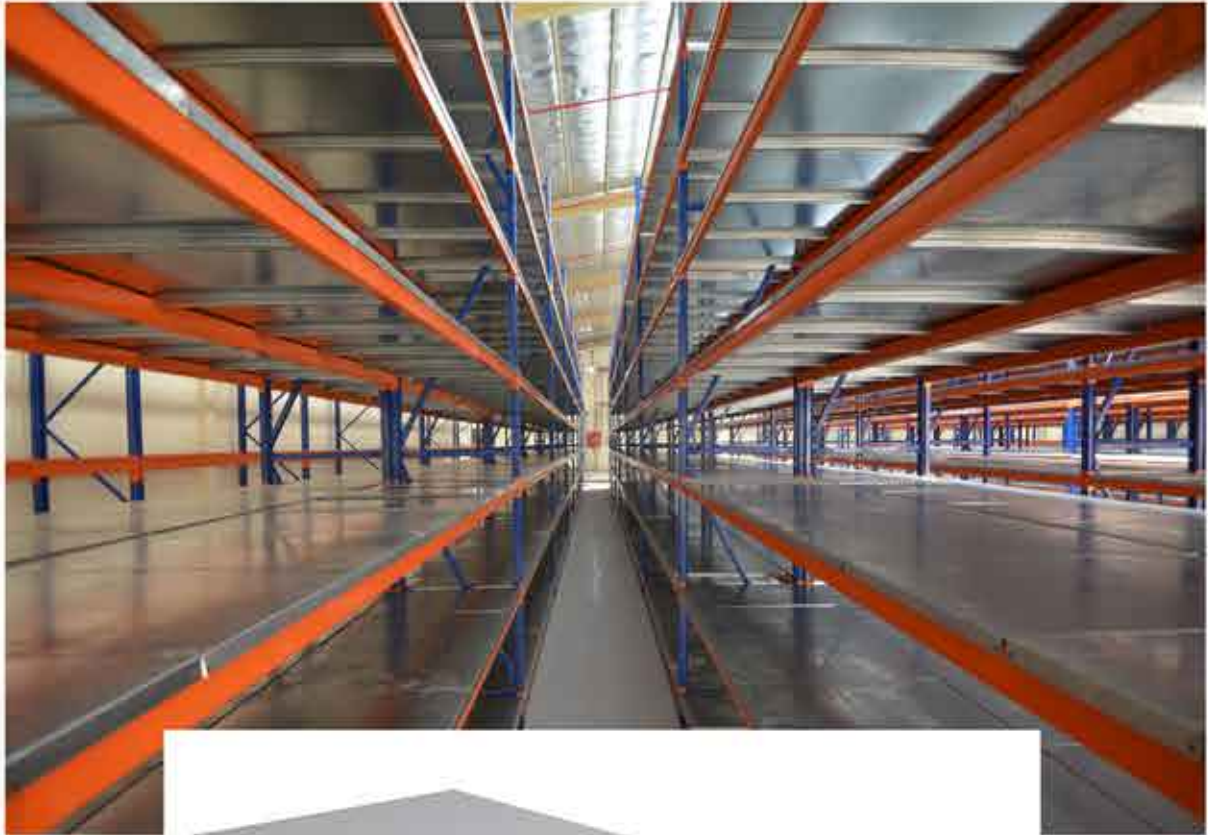

### Shelves

*Different types of shelves are available, to suit any requirement. The most commonly used are:*

**Galvanized Shelf**



**Metal Shelf - HR or CR coil**



*Metal shelves which, depending on the storage requirements, can be placed on tubular or beams they fit directly on top of the beams.*

## Selective Pallet Protectors



### Protectors

These protect racks from light impacts that may occur at floor level preventing damage to the vertical elements.

### Upright Frame Protectors

Each type of upright has its own type of protector. they are 400mm high and come with 4 anchor bolts to fix them to the floor. they are used to protect uprights from impact and possible damage in facilities where forklift truck operate.



### Frame Protectors

These protect the side of the rack at the bottom. they are normally fitted to end frames and passageways between frames where impact are most likely. Each upright type has its own protector. In order to protect the entire side of a frame.



## Selective Pallet Rack Accessories

Drum Chocks



Fork Spacer



Coil Cradles

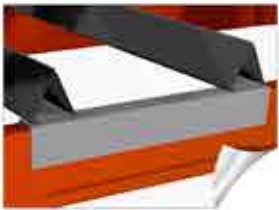

Cladding Support

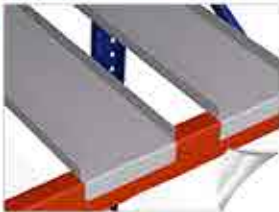

Span Breaker



Profile Panels

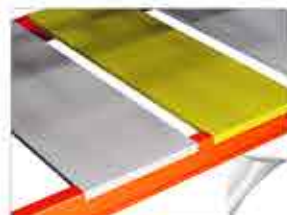

Shelf Panel



Upright Protector





# *Drive-In Pallet Rack*



## Drive - In Pallet Rack



*Drive-in Pallet Racking System provide maximum storage capacity using the minimum amount of space. It is particularly suited to store very large quantities of homogeneous products. Drive-In or Double Access System consist of continuos lanes of racking with only a single load and retrieval aisle. loading and unloading is undertaken be means of counter balance or reach trucks that drive down each lane into the racks. Drive-In racking operates on the basis First-In Last-Out (FILO), therefore it only suits products, which is stored in sufficient volume to require multiple lanes to ensure stock rotation.*

## Drive-In Pallet Rack

*Drive-thru is used to stored many pallets of a similar products.Lift trucks drive into the rack to extract the first pallet they come to. Pallets in the center of the rack system are not accessed as frequently as those edges.*



*Isometric View*

## Drive-In Pallet Rack

### Drive-thru

Drive-thru rack allow a lift truck to enter the from either side to pick up or full out pallets. Loads are supported by rails attached to upright frames, and lift trucks are driven between uprights to reach pallets. This is done because pallets can slide backwards on a continuous rail. It's open at both ends, allowing first-in, first out storage.

Drive-Thru rack offer the ability to store a large amount of similar loads in a smaller area. Selectivity is sacrificed, but storage density is enhanced since many pallets are stored and are available through a single pallet position.

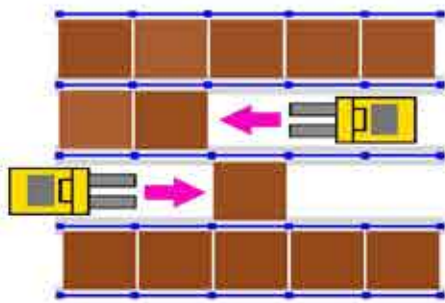

Top view



## Drive-In Components

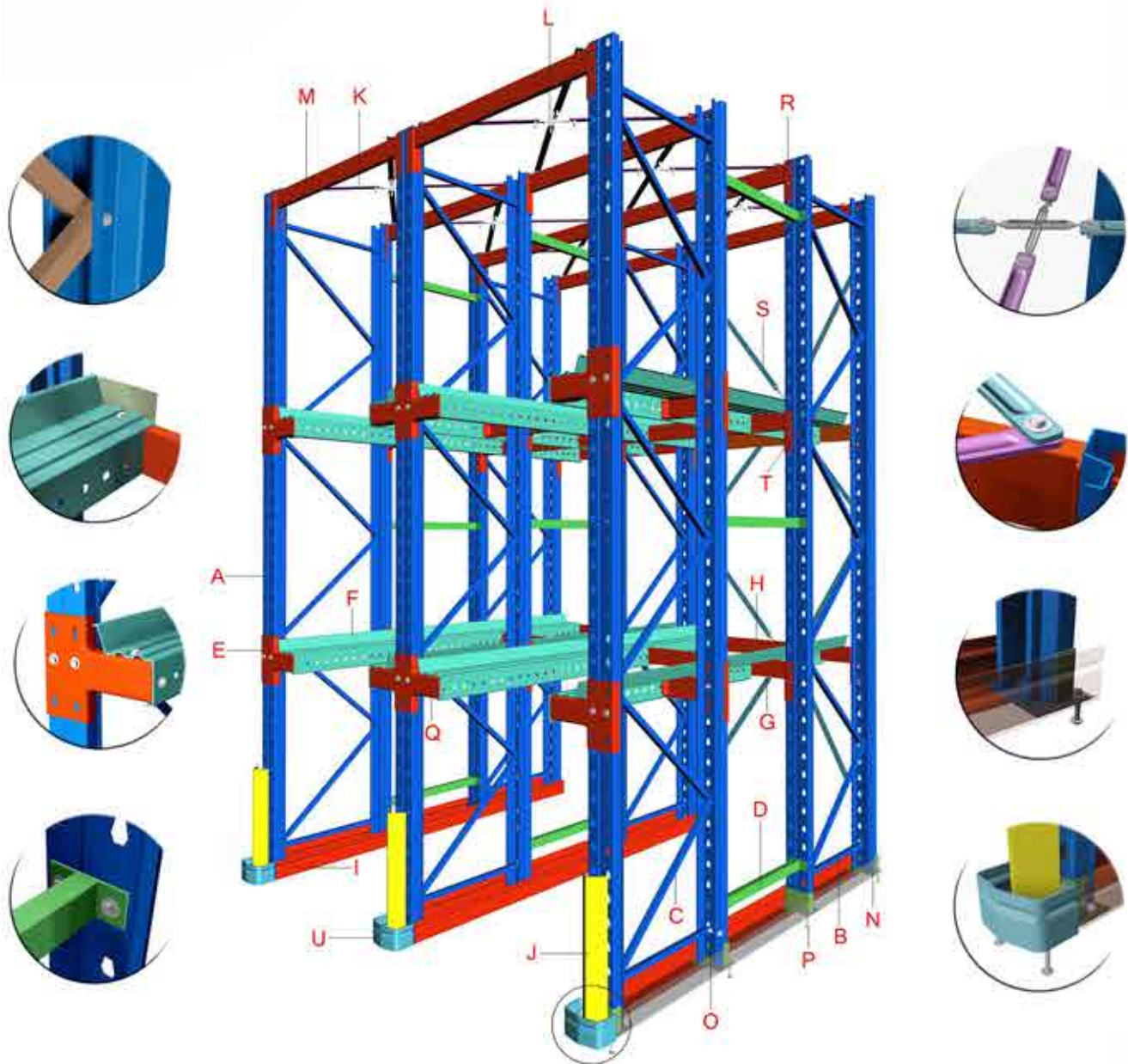

- A: Upright
- B: Horizontal Brace
- C: Diagonal Brace
- D: Cant Arm Single
- E: Guided Pallet Support
- G: Portal Beam with Guided Rail
- H: Portal Beam with Stopper
- I: Floor Guided Rail
- J: Column Guards
- U: End Curve

- K: Top Brace
- L: Turn Buckled
- M: Top Portal Beam
- N: Foot Plate
- O: Small Spacer
- P: Anchor Bolt
- Q: Cant Arm Double
- R: 2 Lip Connector
- S: Back Brace
- T: 3 Lip Connector

## Drive - In Pallet Rack

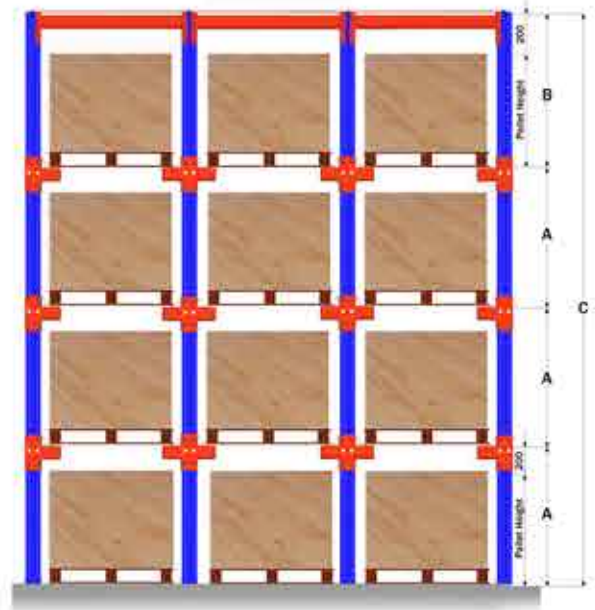
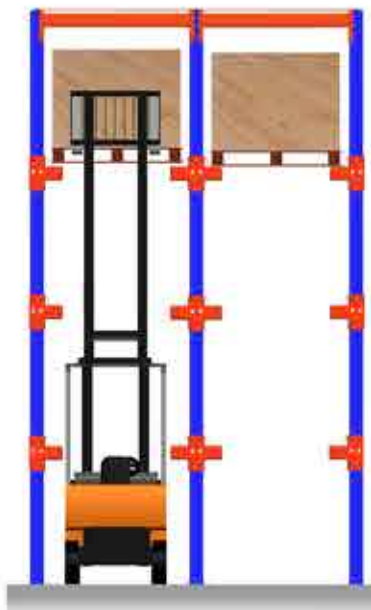

### Height

The minimum height measurements required are as follows:

A = Height of the lower and intermediate Level = Height of the pallets + 150mm.

B = Height of the upper Level = Height of the pallets + 200mm

C = Total height = at least the sum of all the levels.

Dimensions F, G and H must always be multiples of 50mm

## Drive-In Pallet Rack



### Standard Dimensions:

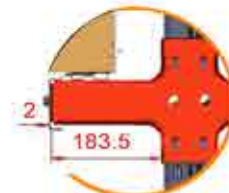
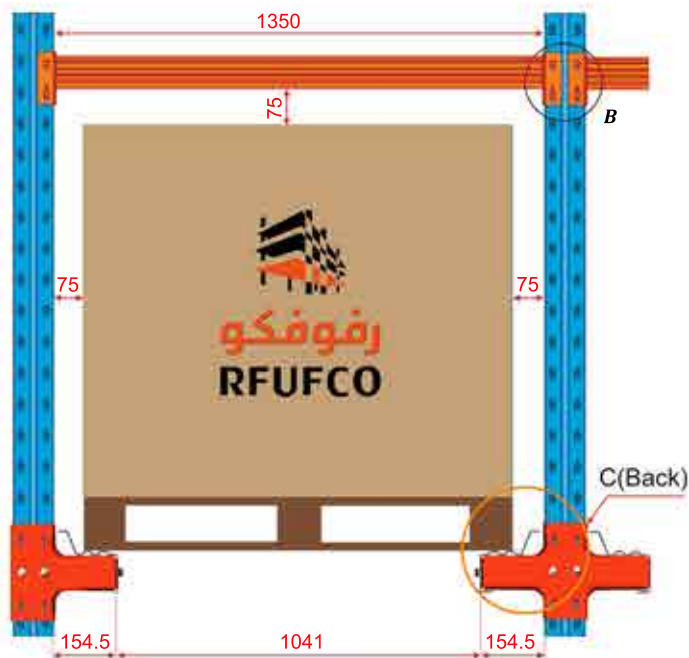

DETAIL A



DETAIL B



DETAIL C

For normal forklift operation

Drive - In Pallet Rack

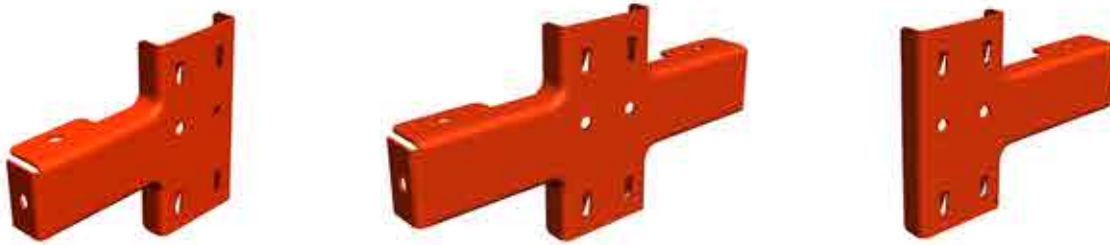
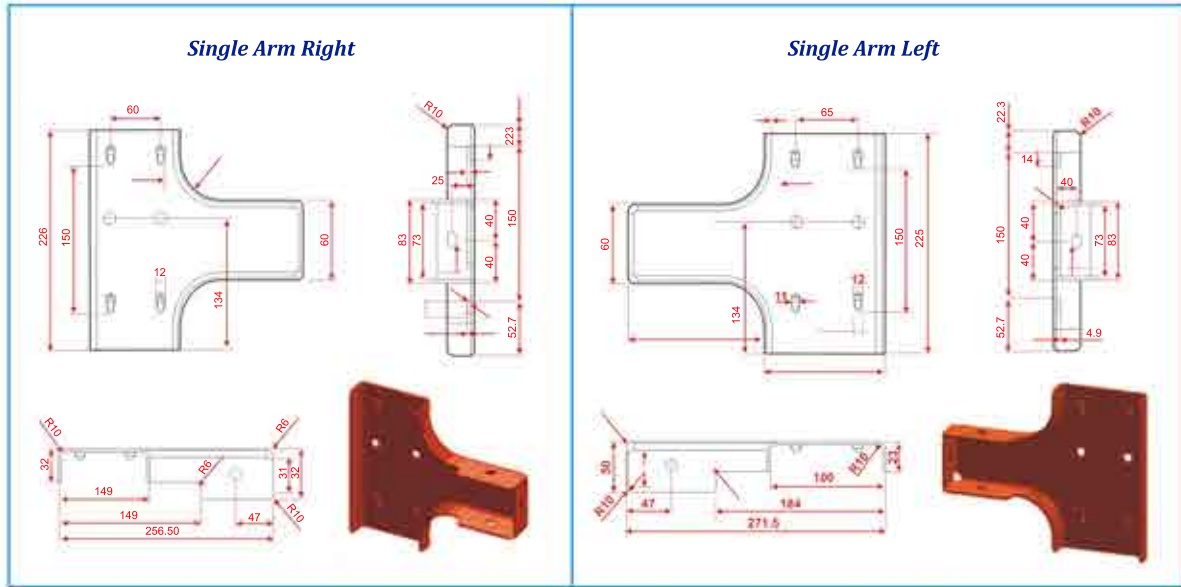

Rail Guided Pallet Support:

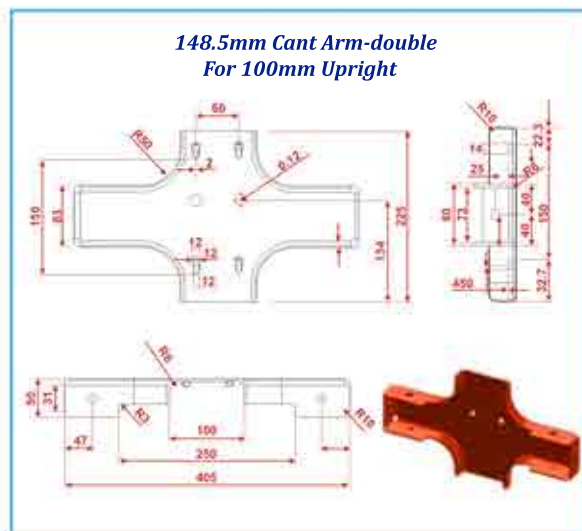
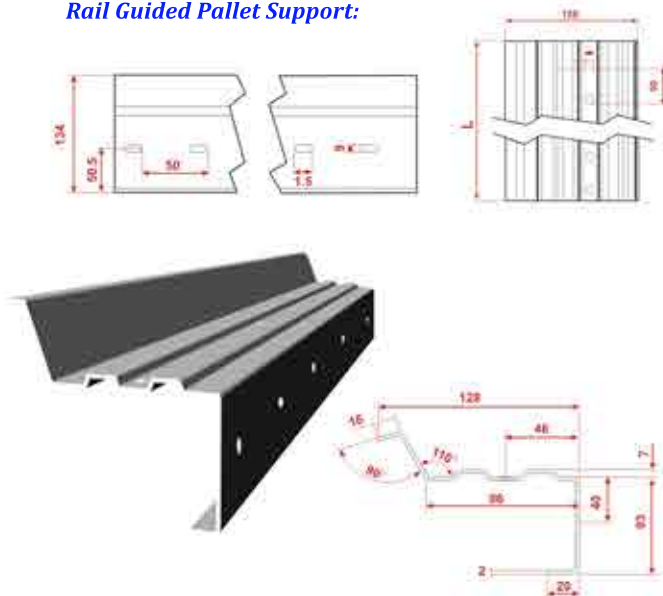



## Drive-In Pallet Rack

### Upright:

Omega section with returned flange and central groove  
 Hexagonal shaped hole at 75mm pitch for Beam levels  
 Circular shaped hole at 75mm pitch for bracing  
 12 Bends upright  
 Made of hot rolled steel  
 Length can be produced with multiplier of 150mm



UPRIGHT 100

UPRIGHT 115

### Upright Sections

Type H	Type X
Section : 90x63.5 Thickness : 1.6, 1.8, 2.0, 2.3	Section : 100x63.5 Thickness : 1.8, 2.0, 2.3, 2.5
Brace 41x17mm with thickness 1.6mm	Brace 41x22mm with thickness 1.6mm

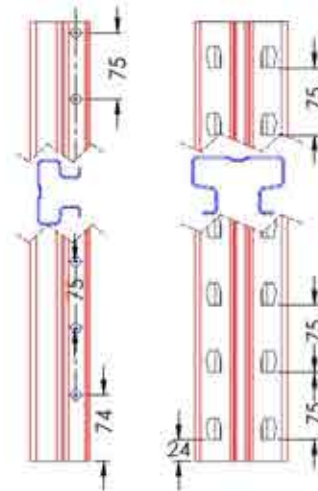

### Foot Plate:

Foot Plate - long (Welded)	
H	A=160, B=60 C=95mm, D=120, E=24.5, H=25mm
X	A=175, B=75 C=109mm, D=130, E=30.5, H=29mm



# ***Bolts Free Shelving Storage***



## Bolts Free shelvings

M3 Shelvings is ideal for offices, bussiness and places that need a more professional looking system.  
The different components are painted in blue ral 5005 ( Frame upright ) and gray Ral 7047 ( other components )

The most common combination are shown in the following illustration



Suspension filing set



### Basic components

1. Suspension filing set
2. Shelvings
3. Vertical divider
4. Side support
5. Back support
6. Base



Book dividers, Lateral retainers, and Vertical dividers

Section of the space, Creating of the components for book or files



## Bolts Free shelvings

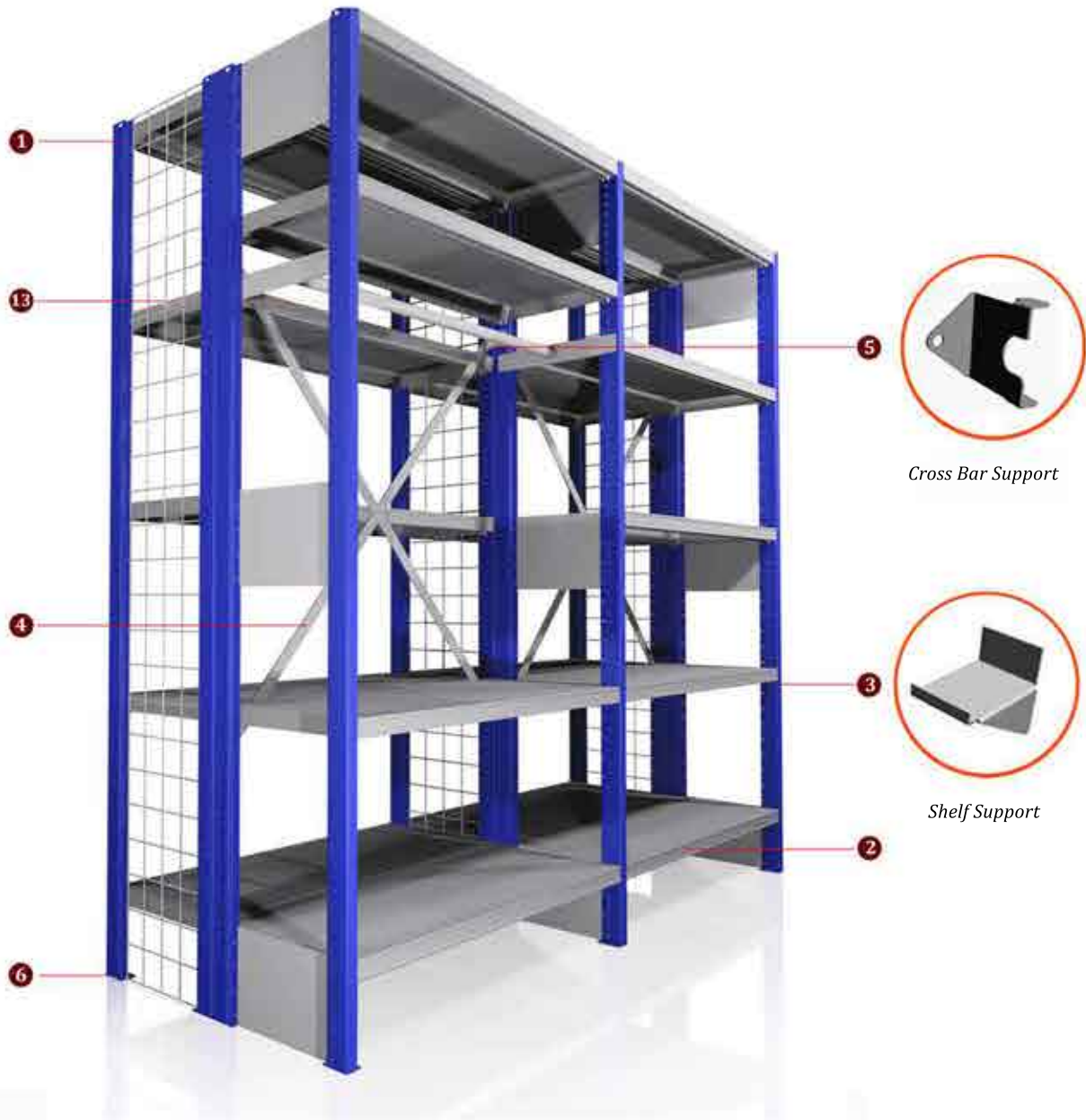

### Basic components

1. Frame
2. Shelf
3. Shelf support
4. Crossing bracing
5. Cross support
6. Foot plate



## Bolts Free shelvings



### Cross Bracing set

Cross bracing set are vital for the stability and longitudinal rigidity of the shelving. They are attached to side slots at back of the uprights to tighten and stabilise the units.



### Number of cross bracing

The number of cross braces used is variable, depending of the height, the number of shelvings unit and the stored loads. For shelves with light loads, one cross braced unit in ten is sufficient.

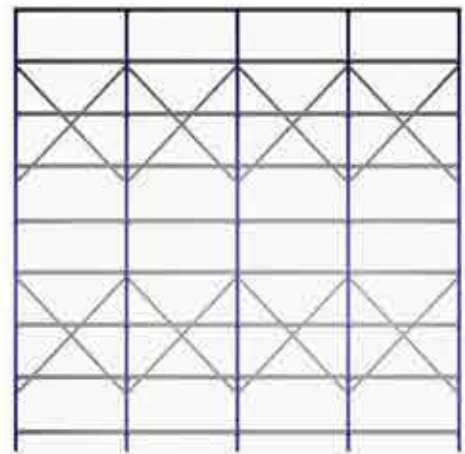
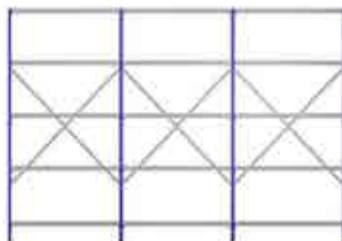

## Bolts Free Shelvings

### **Frames with cross ties and diagonal**

These are basic frames which, in addition to cross ties, include crossed diagonals to increase the level of rigidity in frames in considerable height.



### **Frames with central metal panelling**

These are closed framed that stop products stored on adjacent levels from getting mixed together; the metal panels are made in sections and joined together using panel splice.



### **Frames with metal wiremesh**

These prevents goods from falling off the side as well allowing a lateral view of the products and providing better ventilation.



### **Frames ( Upright )**

Vertical elements created by two upright joined together with cross ties. Side panels of set of cross ties and diagonal providing the necessary rigidity.

The basic frame made up of two uprights cross ties and footplates.

The number of cross ties depends basically on the height of the frame The minimum number used is two. The most common frame height are: 1500, 2,000, 3,000, 4,000mm . They can manufactured up 8,000 long.

### **Footplates**

Suitable for heavy load, as they distribute the weight over the floor.



## Bolts Free shelvings



The various folds on the front and back of the Heavy-duty shelves create a rounded edge, which increases the load capacity. These shelves can be supplied in the slotted option, allowing usage of vertical dividers and accessories.



The channel of the front can be used to attach magnetic holders or sticker for identification label.



### Shelf reinforcer

Heavy-duty shelves can be fitted with the central reinforcer along their length to increase their load capacity.



Shelves for light or medium loads, depending in the load capacity



Shelf

### Shelf Support

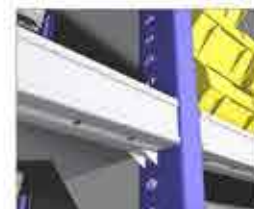

*Bolts Free Shelvings*

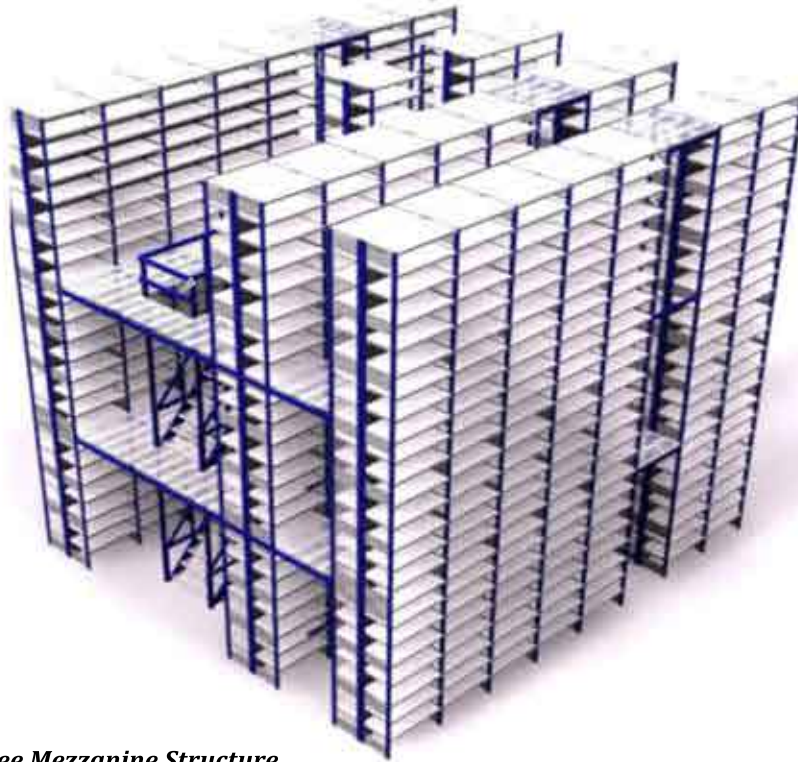

*Bolts Free Mezzanine Structure*

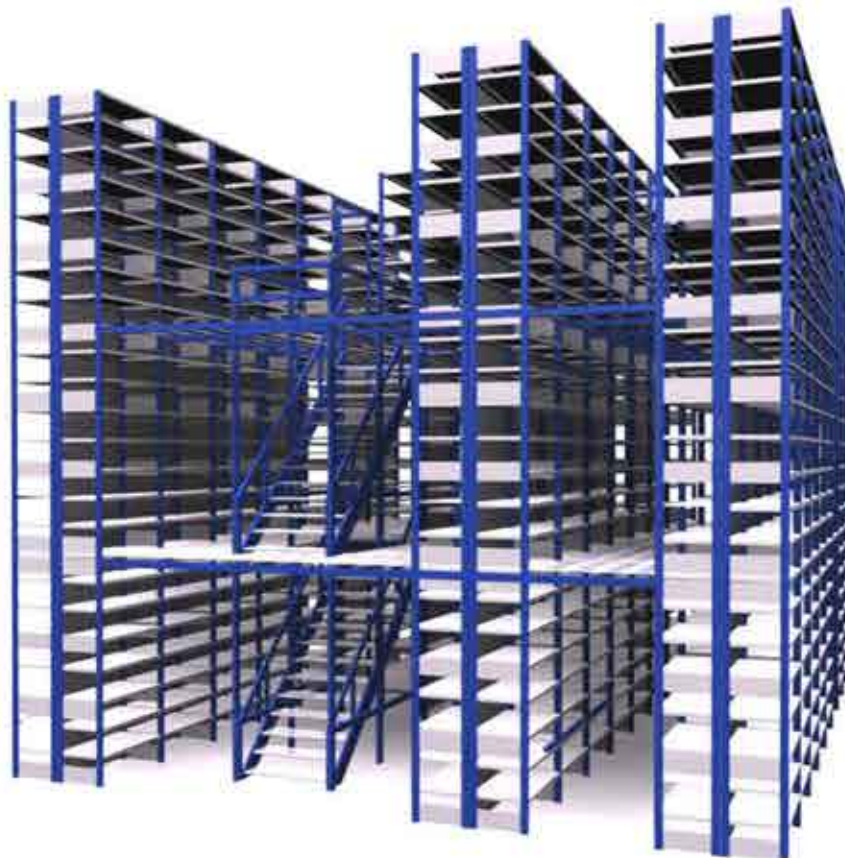



# *Mobile Shelvings*



## Mobile Shelvings Storage



*Mobile shelving system enables workable storage system even in a small space. Modifying stationary shelves into mobile shelves you can have upto two times more using meters.*

*Structure of closed end upright makes it possible to use every inch of the shelf and neither is there no space for material dropping from the end of the shelf. A welded wagon guarantees solid and durable structure.*

*Crank and electricity driven mobiles always have drive in both ends and the longer wagons also have drive in the middle. This guarantees smooth movement and there will not be any stability problems. Ball bearing drives mechanism and o 130mm ball bearing wheel are made of steel.*

*Shelf thickness 30mm*

*Adjustment in height 25mm*

*Max load 80kg / shelf, even load ( up to 150kg / shelf for special order )*

*Horizontal ang diagonal bracing ( diagonal bracing attach shelves to wagon )*

*It is possible to order decoration plate in any color from the RAL color map.*

*It is possible to cover the mobile shelves with veneered plates.*



## Mobile Shelvings Storage



**Driven System**

*Mobile Shelving offer maximum filling and storage capacity in the available space without compromising access. Precision built to a high standard of quality, the units provide optimum filing capacity for the modern office or the heavy demands of storerooms. It consists of a secured enclosed shelving unit on a track at one end and a series of enclosed lockable shelving units that slide to allow access to contents within them and isle space.\*

*Mobile shelving consists of base, frame, driven system, safety device. Frame includes upright, shelf, panel, hanging panel, roof panel, etc. It is dismountable, spare parts could be final assembled in site. The parts are Bolted & rivet joint, combine easy installation and stable frame.*

*Aceally Compactus provides high capacity in-office storage together with speed of access. Create additional workspace with this economical solution providing high volume storage of items that need to be closed at hand*

*Unlike older style Base Mounted Systems, Compactus is far more flexible, Not restricted by track length you can tailor a system to suit your available space. Simply cut tracks to required length.*



Mobile Shelvings Storage



Components of mobile shelvings

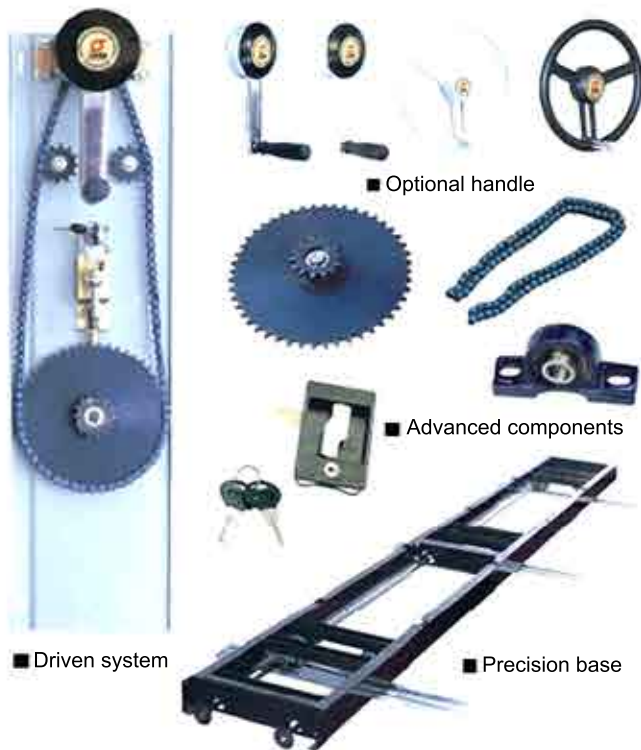

Design of track

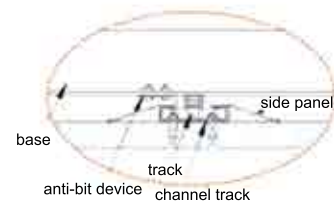

section drawing of side panel cover model

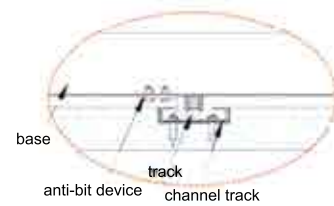

section drawing of embedded track

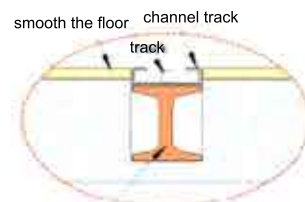

insert both ends of H profile steel into load wall

section drawing of enhanced support

## Mobile shelvings



*It is a set of shelving units mounted upon mobile bases which move along rail. Thereby guaranteeing optimal order and distribution of the archive and warehouse, as well as a better used of space.*

### **Advantages**

- *Great use of space as it is a compact storage system.*
- *Can be adapted to any available space.*
- *Total safety of filed materials.*
- *Ideal for the storage of all types of book and documents.*
- *When the shelves reach a high height, ways fitted half-way up enabling the upper levels to be accessed can be installed.*



# *Mezzanine floor Storage*



## Mezzanine Storage System

*Mezzanine storage* are essential to most modern warehouse, factories, and other industrial facilities. Used to storage goods or create additional work or areas, they incorporate features such as cat ladders for access, parcel chutes, and pallet gates.



## Mezzanine Storage System



*Mezzanine Storage* allows you to utilize overhead space for additional offices, record archival or general storage. The key benefit of it is the ability to create new space fast and efficiently.





## Mezzanine Floor Storage



*A basic manual storage and archive system for light and medium loads. Combining the different components offer a whole range of features.*

*The main advantage are:*

**Endless Storage Possibilities** from plain folder to all kinds of parts, boxes, clothes, bulk goods, etc

**Multiple Components** that adapt to suit even the most demanding needs

**Easy to assemble**  
**Level adjustments** in multiples way

Increased capacity due to the fact the **minimal space** is used for uprights and shelf panels.

It is possible to install **one or more walkways** to gain access to upper levels.

**Mobile shelvings** can be made for archives and warehouses.

**Functional and attractive**, for the office version, the units can be finished to suit your decor

## Mezzanine Floor Storage



*Mezzanine storage* are suspended or supported floors erected within a building. A mezzanine floor provides additional work or storage space without adding to the building's original footprint something for nothing almost! This storage contains information on industrial and commercial/ retail mezzanine floor, and the options available. There is a mezzanine floor application library, featuring installations in many industry sectors and geographical regions. You will see who is buying red floor and what they think of it You can also find details of relevant building regulations and safety standards, a mezzanine floor gallery, and various downloadable brochures.



## Mezzanine Floor Components

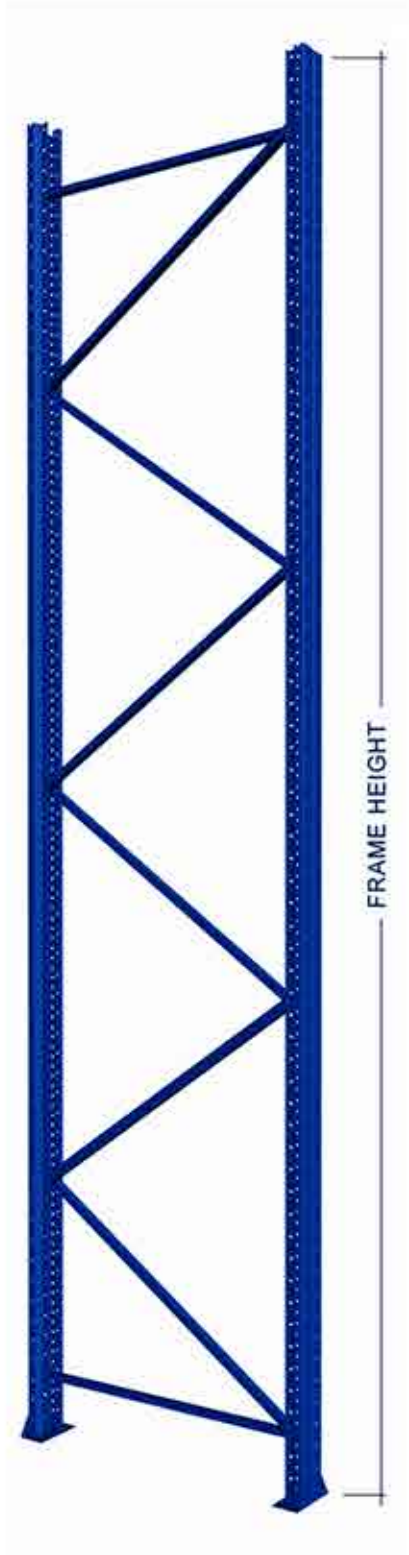

### Frame ( Upright )

Vertical elements created by two uprights joined together with cross ties. Side panels of set cross ties and diagonal providing the necessary rigidity.



### Beam

Beams are the horizontal and robust component of the rack upon which load are deposited. they are joined to the upright via connectors or endplates, which fit into the slots of the upright.



### Mezzanine Shelf ( Galvanized )

Metal floors are manufactured out of galvanized steel and have a high load capacity. The different models come in a variety of slotted or perforated surfaces depending on the ventilation requirements and the water supply in fire protection system.

### Shelves

Metal shelves which, depending on the storage requirements, can be placed on tubular or beams they fit directly on top of the beams.



# *Mezzanine Platform Storage*



## Mezzanine Platform Storage



*Installation of a mezzanine or elevated platform is one most economical ways to create additional storage space in a warehouse, distribution center or industrial or manufacturing facility where high ceiling exist. Storage mezzanine and elevated platforms allow storing uniform or odd-size parts, machinery, equipments, supplies or other bulk items at floor levels as well as above, nearly doubling the storage capacity of the available floor storage.*



## Mezzanine Platform Storage



**Mezzanine are steel structure made out of main beams and columns. They create new elevated surfaces on warehouse or premises floors, enabling extra space for storage, work areas, offices, in a quick and in expensive way.**

*In order to offer the ideal solution in each individual case. Has three mezzanine constructive system to choose from based on the load, the distances between columns and the use for which they are intended. When designing a mezzanine floor with any of the mentioned constructive system, the constraining factors within each case are taken into account. These include factors such as accesses. The work system, the product the loading and unloading area.*



## Mezzanine Platform Storage



Zigma Post



Zigma Beam

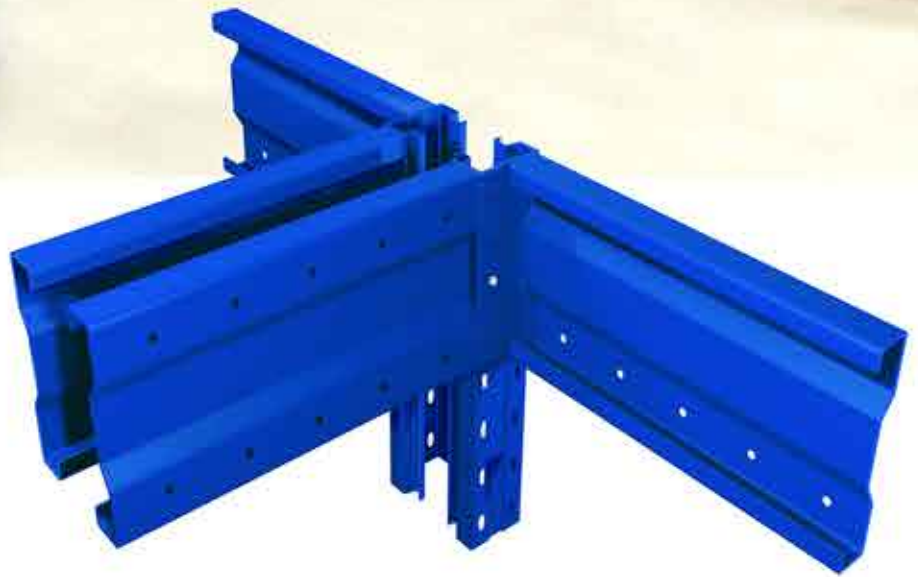

### Zigma System

*This type of mezzanine are composed of cold-profiled elements both the columns and the beams with zigma profiles are manufacture in various heights, length, thicknesses drill hole diameter.*

*zigma cold-formed, steel profiles can act as main beams, and as secondary beams that rest on the main beams. its standardised length is between 1,000 and 12,000 in 250mm section, with a height ranging 240 to 400 mm and width of between 100 and 120.*

## Mezzanine Platform Storage



### Mezzanine Galvanized Metal Floor

Metal floors are manufactured out of galvanized steel and have a high load capacity. The different models come in a variety of slotted or perforated surfaces depending on the ventilation requirements and the water supply in fire protection system.







# *Light Duty Storage*

## Light Duty Pallet Rack



*Light duty rack is the most popular series and best selling product, it has found wide application in industrial, institutional commercial and many fields.*



*Light duty Pallet Rack*



## Light Duty Storage



### **Level composed of beams and shelves**

*Each level has minimum of two beams fitted with shelves or panel*

### **This is the ideal system to store:**

- Boxes, pockets, loose material
- Heavy load in medium-sized storage spaces
- Medium -sized loads in large storage spaces
- Bulky products.

*The rigidity resulting from fitting the beams to the frame is usually sufficient to guarantee the stability of the shelving, and therefore a basic rack only requires frames, beams and shelves. The latter may be made of metal, chipboard mesh.*

## Light Duty Storage



*Storage system for manual picking of products following the "man to goods" principle.*

**Main Benefits are:**

- Possibility of storing medium to heavy loads
- Adjusting between multiple level of 25 or 50mm, depending on the construction system used.
- Racks up to 20m high can be built.
- Possibility of installing one or several gangways to gain access to upper levels
- Easy assembly
- Excelent mobility



## Light Duty Rack Components



The most regularly used construction systems are made of beams and shelves or by shelves and supports.

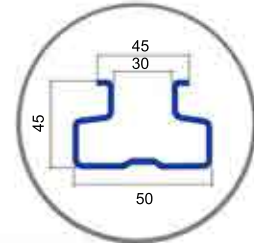
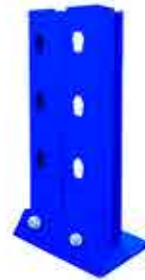

### Upright

Composed of two uprights with the corresponding bracings, footplates and accessories.  
The different depth enables the shelvings to be adapted to sizes of the product to be stored.  
Diverse upright models, and thickness easily adjust to a variety of loads.

### Shelves

Metal shelves which, depending on the storage requirements, can be placed on tubular or beams they fit directly on top of the beams.

#### Galvanized



#### Metal Coil - HR or CR

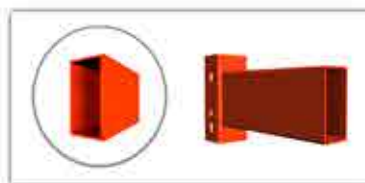

### Beam

The beams are horizontal components where loads are deposited or where shelves are placed to store small-sized products. They are joined to the upright by means of connectors which fit into their slots.

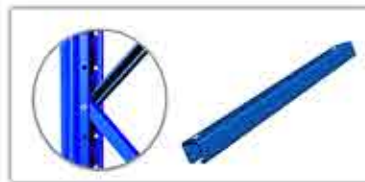

### Upright Support

Use connect frames & frame ( double side ) of frames and upright  
Length as required



### Footplate

The frame are fixed to the floor by means of footplates which are placed at the base of the upright. Different footplates are available depending on the upright model anchor bolts can be fitted to the shelving when required.

# *Very Narrow Aisle ( VNA )*



## Very Narrow Aisle ( VNA )



### Facts about Very Narrow Aisle ( VNA ) Pallet Racking System

- Good Stock Rotation
- Good Order picking; 100% selectivity
- Fast Picking rate
- Good product protection
- Average Floor area utilization  
50% net pallet area usage of overall warehouse area
- By increased operational height, can increase warehouse capacity by an additional 40% compared with selective racking systems
- Requires super flat floor
- Limited pallet redundancy as system can run at 95%+ capacity  
RF controls on the MH equipment will ensure maximum pallet cycles per hours  
Commonly used with Pick Up and Despatch ( P&D ) stations at end of each aisle
- A smaller reach or counterbalance truck is generally used in conjunction with the operation of the VNA MH machine, to maximize operation when within the aisle
- Mechanical Handling Equipment
  1. Specialist VNA machine - requires super-flat floor surface
  2. Operates within guide rails, standard or low profile, or using a wire induction guidance system which operates to a maximum height of 15m





## Very Narrow Aisle ( VNA )

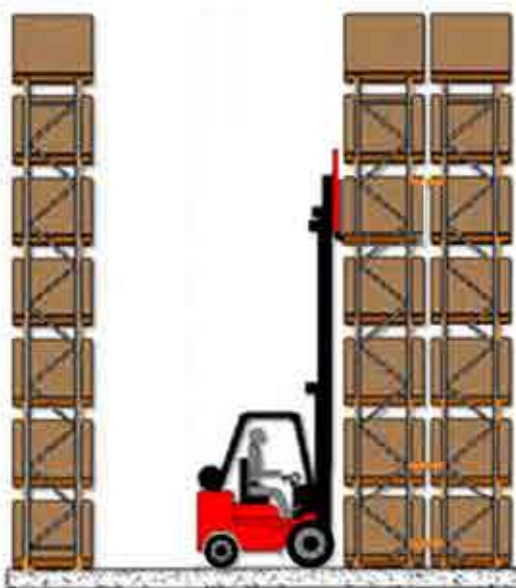

*Standard Pallet Rack Configuration*

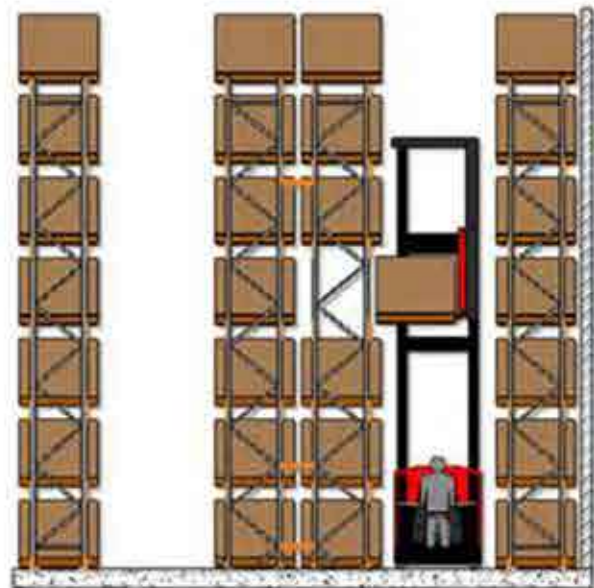

*Very Narrow Aisle Rack Configuration*

*Very Narrow Aisle ( VNA )*



# *Double Deep Pallet Rack*



## Double Deep Pallet Rack



### Facts about Double Deep Pallet Racking System

- Lower beam level required for some types of equipments
- Operates up to height of 10m
- Average stock rotation
- Average order picking, 50% selectivity
- Average Floor area utilization 40% net pallet area usage of overall warehouse area
- Redundancy rates can run between 10-20% dependant on the quality of the WMS programme
- Popular against Drive-in Racking, as a lower cost alternative which increase capacity over selective by up 30%
- Recommend the use of pallet rails or pallet support bars above 4m. to increase MH productivity and improve safety of the operation.
- Recommend to use colum protectors when using MH equipment that requires the straddle leg to go below bottom beam or between pallets and upright
- Mechanical Handling Equipment
  1. Specialist machine with either pantograph or telescopic forks, or using a purpose designed attachment, which can be fitted to standard reach truck.

## Double Deep Pallet Rack

### TOP 5 Benefits of double deep racking

- 1) Efficient use of floor space with a good aisle/shelving ratio
- 2) Increase storage density by around 30-40% with good selectivity
- 3) Keep product lines together by storing two pallets deep
- 4) Easily reconfigured to adjust shelf levels or convert to selective racking
- 5) A cost-effective racking configuration

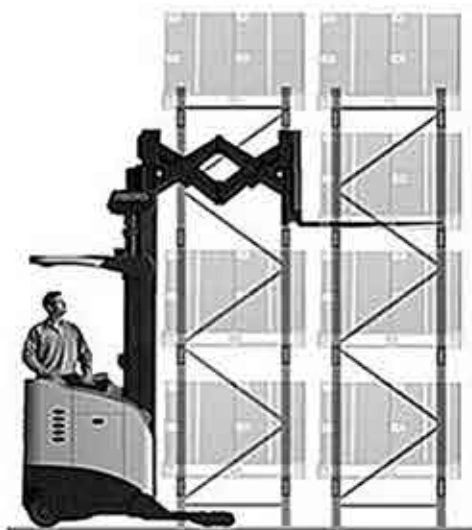

Double -Deep A gainst wall

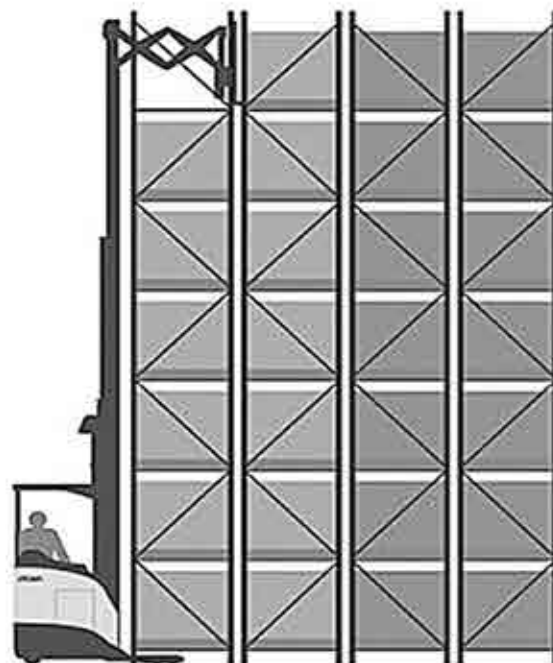

Double -Deep Back-to-back

## Double Deep Pallet Rack

The **Double-deep** racking system is designed to increase storage capacity, double-deep racking system is capable to store two pallets deep into the single-entry rack or four pallet deeps in a double entry rack. Back-to-back racks are four pallets deep, reducing both the aisle-to-rack ratio and selectivity.

This system is particularly beneficial when the throughput is low while fast movement of pallet is not critical. A special reaching truck with double-pantograph or extendable fork is used in this racking system.

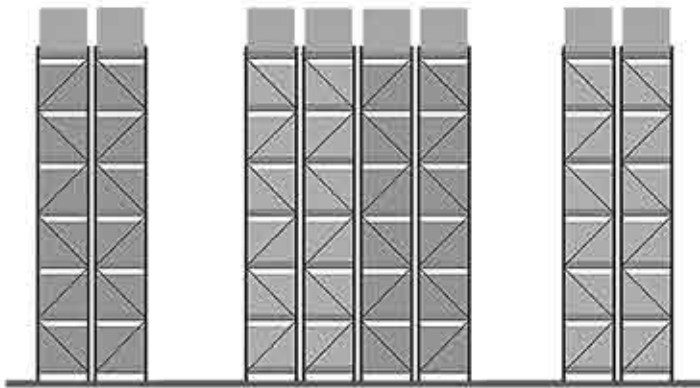

Side Elevation



# *Radio-Shuttle Pallet Rack*



## Radio-Shuttle Pallet Rack

Automatic Shuttle able to transform into an automatic warehouse all the Drive-in racking system, assuring the maximum use of the warehousing, making the facility more productive and efficient, AUTOSAT, powered by an innovative Lithium Ion battery easy to recharge and managed by an interactive radio transmitter, moves goods on pallets into the drive-in channels. AUTOSAT can be placed

in the appropriate channel by means of a standard fork lift.

### STANDARD EQUIPMENT

- Battery on board
- Lithium battery charging station
- Remote Controller
- Remote controller battery charger
- User manuals
- Wooden Box as packaging.



### STANDARD FUNCTIONS

- Loading
- Unloading
- Continuous
- Distance between pallets 40 mm up to 150 mm
- AUTOSAT Manual mode



### STANDARD FUNCTIONS

- Pallets rearrange "compacting push"
- Pallets rearrange "compacting pull"
- Un-Collision between AUTOSAT in the same channel
- Stock list: counting pallets
- Multiple Pallets: different depth pallets management in the same channel
- Continuous unloading "plus"



### TECHNICAL INFORMATION

- Speed with load on board : 30-33m/min Speed without on board : 63-66m/min
- Working range : 10-12-16 H
- Working temperature ST : From + 5 C up to + 45 C / BZ: from + 4 C up to 30 C
- Colors : chassis RAL lid RAL 7035



## Radio-Shuttle Pallet Rack



### **Radio-Shuttle**

*A Radio-controlled, battery operated independent shuttle cart units travel along rails that support pallets above. The shuttle cart travels below the pallet, then elevates a pick-up table that lifts the pallet from the rails and carries it to the front of the racks. From the front of the rack, a conventional forklift truck can select the shuttle cart from its rail and move it to another location.*

## Radio-Shuttle Pallet Rack



### Operation

*in semi-automated installation, operator only need to drive the forklifts that carry the pallets and initiate the motorized shuttles activity. the movement of the shuttles inside the racks is automated.*

#### Step 1



*A forklift places the pallet shuttle in the channel where work is to be done.*

#### Step 2



*Next, The forklift is used to position pallet one in the channel entrance, resting them on the load-bearing beams.*

#### Step 3



*Using the tablet, The operator sends the command to the shuttle to start the loading operation. Once the location of the pallet has been identified, the pallet shuttle lifts the pallet slightly, and moves horizontally until it reaches the first available location, Whereit deposits the pallet Different sensors accurately control the movements of the load being stored.*

#### Step 4



*The pallet shuttle returns to the top of the lane in order the repeat the operation with the next pallet, and the next, as many times as necessary until the channel is filled. Before the last position is filled, the shuttled is removed is the sequence is repeated in the next channel where work is required*

## Radio-Shuttle Pallet Rack



### Components

*Safety and control: the foundations of which the system is built*

*In addition to the control tablet the communicate orders to the shuttle via Wi-Fi the system consists of two basic components.*

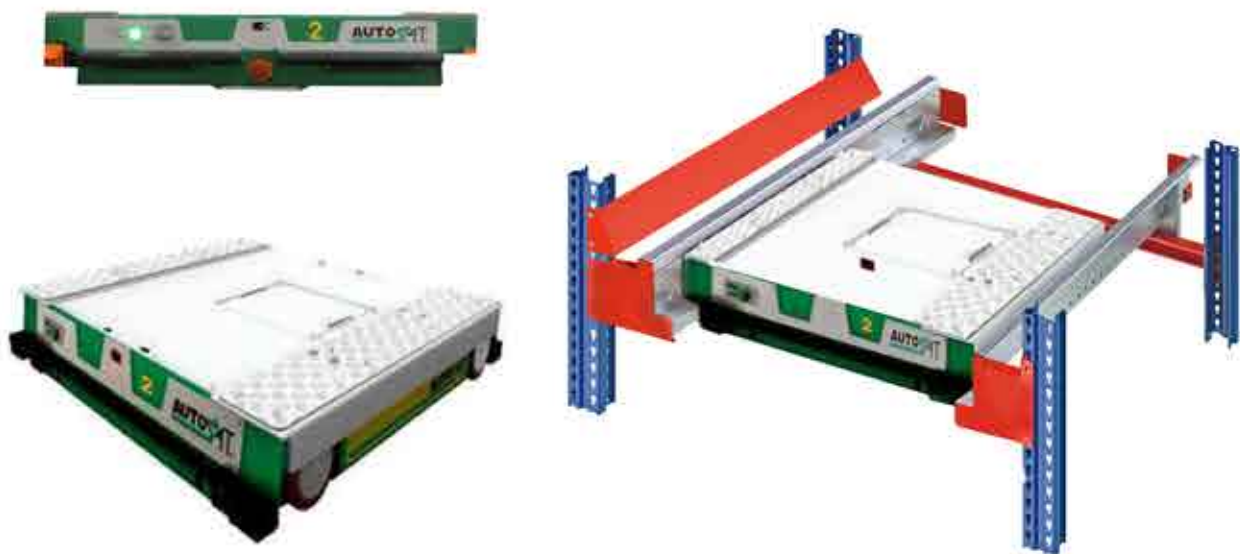

## Radio-Shuttle Pallet Rack Components



### **Upright**

*They are the vertical components can be adapted to a wide range of the load requirements.*



### **External Rail support**

*These are used to fix and anchor the rail at each load level to the entry/exit frames outer upright.*



### **Rail**

*The pallet shuttle runs on rails inside the storage channel. Its design facilitates the loading and shuttle centred.*

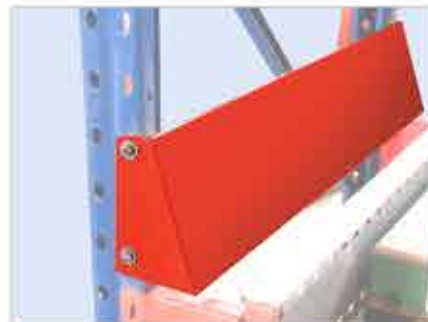

### **Pallet Centraliser**

*These are fitted to the entry/exit points in the storage channels to aid in the placement of the unit load in the channel, ensuring it has been centred*



### **Rail-end stop**

*Made of folded sheet metal, in 8mm thick L-shape, these are used as a detection element to slow and stop the shuttle in normal working conditions.*



### **Beam**

*They are the the horizontal , Robust racking components where loads are deposited*

# *Cantilever Rack Storage*



## Cantilever Specification

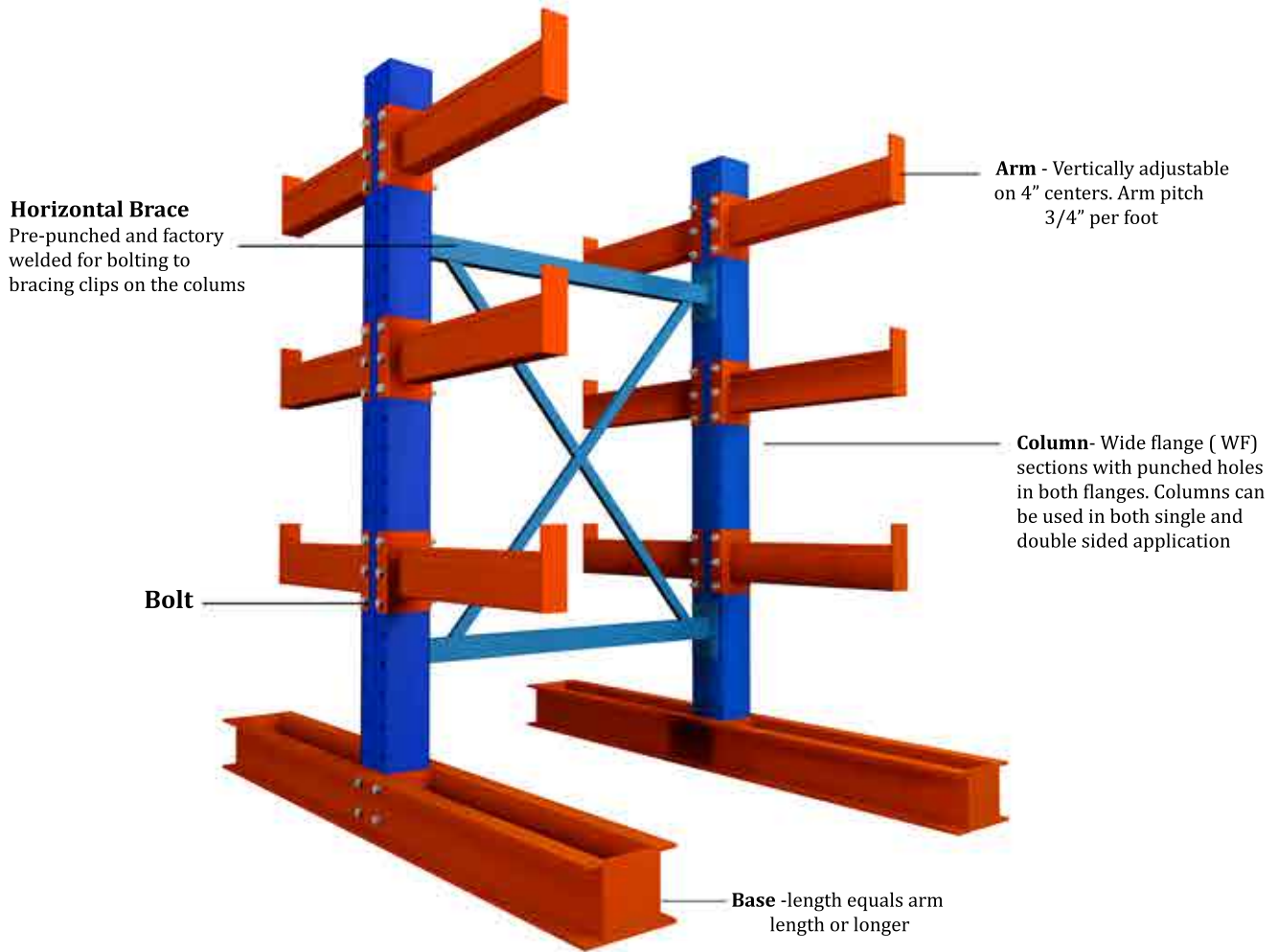

### Determine the Length of the arms

The depth of the load should never exceed the length of the arm. A 48" wide bundle of plywood requires a 48" long arm, bundles of steel 24" wide requires a 24" arm and so on. Rated arm capacities may be seriously diminished if proper loading techniques are not observed. Figures B1, B2 and B3 illustrate incorrect arm loading.

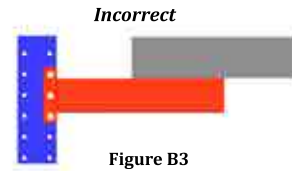
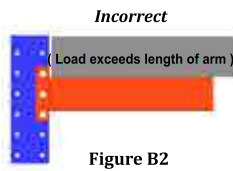
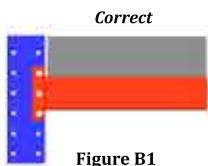

**NOTE:** All arm capacities are based on an evenly distributed load as in figures B4 and B5 below

Evenly Distributed Load  
(front to back)  
Full rated arm capacity

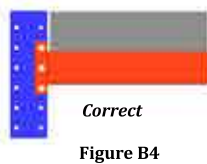

Centered Load  
Full rated arm capacity

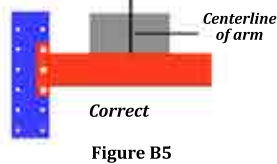

Tip Loading  
Arm capacity may be reduced by up to 50%

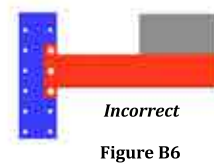

## Cantilever Rack Storage

### Cantilever Rack

**Easy to build and reconfigure**

*Quickly gets your storage organized*

**Frames capacities up to 1750kgs**

*Arms carry loads up to 185kgs*

**Single or double sided configuration**

*Frames available in 3 heights 2 depths*

**Optional end stops available**

*Secure any loose items from falling off*

**Strong powder coating finish**

*Blue RAL5010 coordinates with our shelvings systems*



*Cantilever for dram tank*



*Cantilever for cable roll*



*Cantilever for lumber*

## Cantilever Rack Storage



*Cantilever racking is specially designed to store long loads such as beams, profiles, pipes and timber*

**Cantilever Storage** is widely used in many industries for storing materials such as tubing, pipe lumber and other items with long length, irregular shape or configurations.

They are also used extensively in the lumber and building materials business for outdoor yard storage structures such as T-sheds, and rack supported drive-thru buildings.





# *Supermarket Shelvings*



## Supermarket Shelvings



*Island Gondola*



## Supermarket Shelvings



*Double Island Gondola*



*Car Accessories section*



*Book & Toys Section*



*Supermarket section*



*Hardware tools Section*

## Supermarket Shelvings

### Standard Dimensions of the Shelving

The Diagram shown below refer to the standard dimensions of the suspended shelves and base shelves



Suspended Shelf



	W WIDTH ( mm )	D Depth ( mm )	Number of reinforce- ment
SHELF	1000	300	1R
	1000	400	2R
	1000	500	2R



Base Shelf

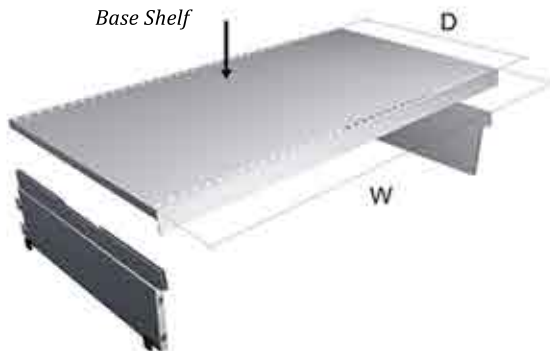

	W WIDTH ( mm )	D Depth ( mm )	Number of reinforce- ment
BASE SHELF	1000	300	2R
	1000	400	2R
	1000	500	3R

## Supermarket Shelvings



STANDARD DIMENSIONS FOR WALL GONDOLA SHELVINGS

H Height (mm)	W WIDTH (mm)	D Base Depth (mm)	T Thickness (mm)	P Shell Depth (mm)
1700	500	300	80	300
1950	750	400	100	400
2200	1000	500	140	500
2450	1250	600	-----	600
3200	-----	-----	-----	-----



STANDARD DIMENSIONS FOR ISLAND GONDOLA SHELVINGS

H Height (mm)	W WIDTH (mm)	D Base Depth (mm)	T Thickness (mm)	P Shell Depth (mm)
850	500	300	80	300
1200	750	400	100	400
1450	1000	500	140	500
1700	1250	600	-----	600
1950	-----	-----	-----	-----
2200	-----	-----	-----	-----
2450	-----	-----	-----	-----



Island Gondola  
w/ Hole Back Panel



Island Gondola



End Gondola

*Supermarket Trolley and Basket*



## Supermarket Trolley and Basket



# *Promotional Display Stand*





## Promotional Display Stands



Promotional Display Stands



## Promotional Display Stands



# *Guns Racking Storage*



## Gun Racking Storage



## Gun Racking Storage



*Isometric Continuous Stand*



*Single Sided Stand*



*Double Sided Stand*



*Single Sided Wall Stand*

# *Plastic Stacking Bin*



## Plastic Stacking Bin



<b>Plastic Bin Advantages</b>			
 <p>CODE - 2250 size - 175x300x150</p>	<p><i>Plastic Bin Manufactured from high Quality anti static grade polypropylene. Used in Hanging louvered panels, shelves, racks and trolley, Ideal for live storage or conveyor applications. Semi - open front, smooth finishing and clean inside faces to eliminates dust traps. Provisions for holding identification card Resistance to most industrial solvents and virtually indestructible Reinforced base and edge to ensure safe stacking and handling Available in five standard sizes and four attractive colours. Utilized cubic load capacity stackable</i></p>		 <p>CODE - 2249 size - 102x170x74</p>
 <p>CODE - 2254 size - 340x510x250</p>	 <p>CODE - 2253 size - 340x510x200</p>	 <p>CODE - 2252 size - 260x400x200</p>	 <p>CODE - 2251 size - 260x400x150</p>



## Plastic Stacking Bin



CODE - 2258  
Metal Cabinet with Bins



CODE - Stand 2261  
size -1050 x 860 x 1800



Usefull in warehouse that handle multiple and small sized such as parts. warehouse workshop and manufacturing plants, They can be used as independent units for classification and storage, or they can be joined by a union clip to form a compact drawer system, when placed in shelving. the ease and the speed of locating products is significantly improved. They are made of polysterene, which makes them long-lasting and highly cost effective.

## Plastic Box Bin Container

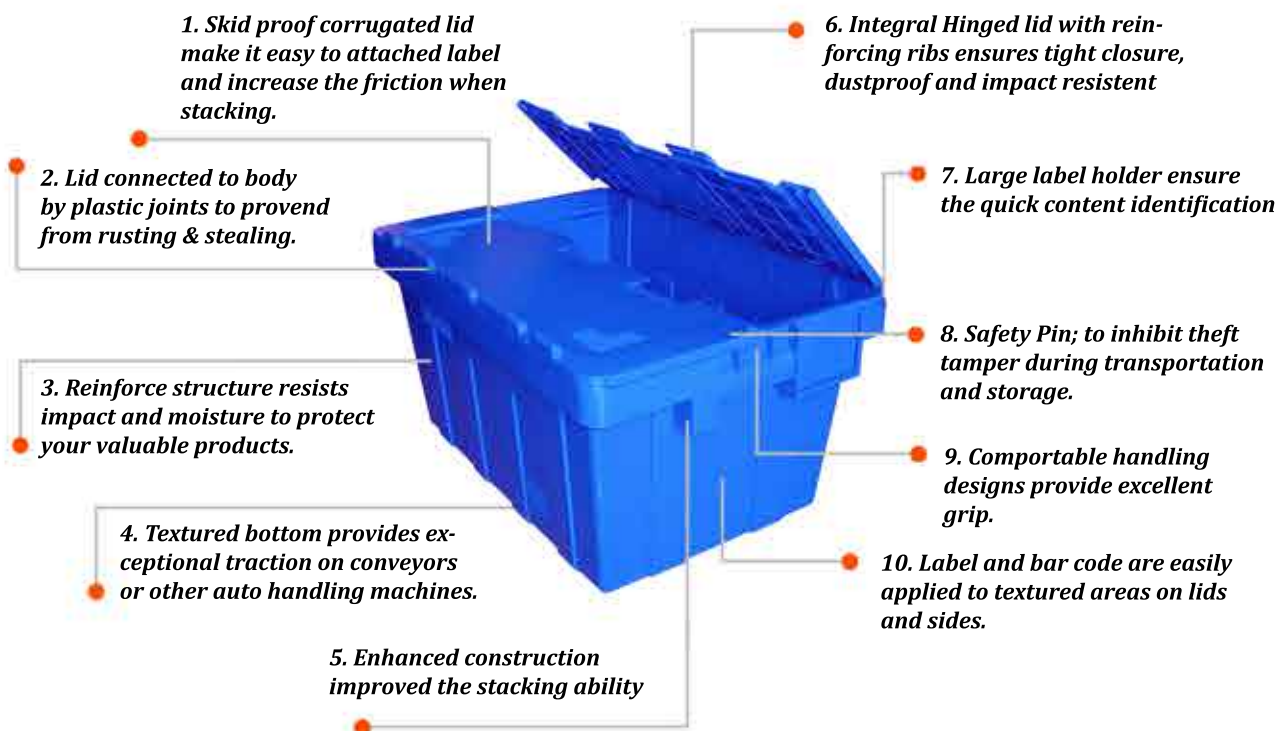
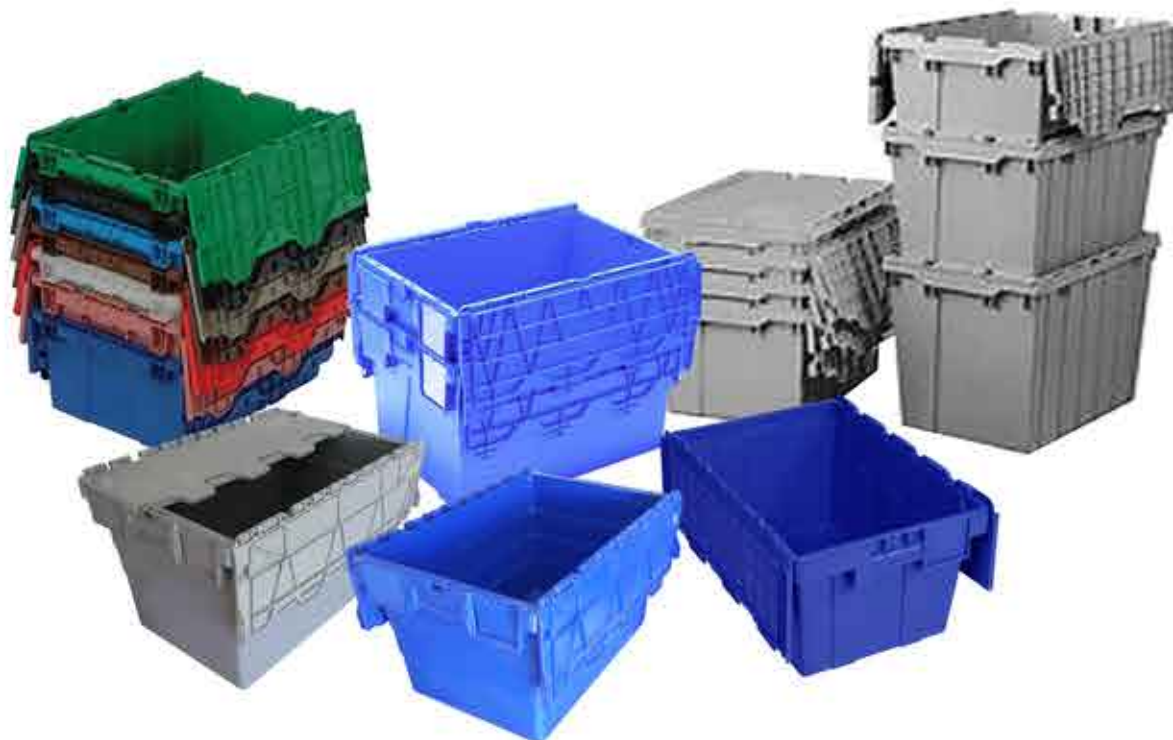

## Plastic Box Bin Container

Size - 400mm x 600mm x 365mm



Size - 400mm x 600mm x 230mm



Size - 400mm x 600mm x 416mm



Size - 300mm x 400mm x 220mm



Size - 400mm x 600mm x 355mm



Size - 400mm x 600mm x 410mm



## Industrial Metal Cabinet & Trolley



*Stationary steel drawer with filling rack*



*Stationary Metal Drawer*



*Drawer Box Single Sided Stand*



*Hobby Stand*



*Metal Trolley with Drawers*



*Table Office Stationary Metal Drawer*

## Industrial Metal Cabinet & Trolley



Code - 2259  
Trolley with Drawers



Code - 2260  
Trolley with Drawers



Code - 2271  
Metal Trolley with Drawers



Code - 2270  
Metal Trolley with Drawers



Code - 2263  
Material Cabinet

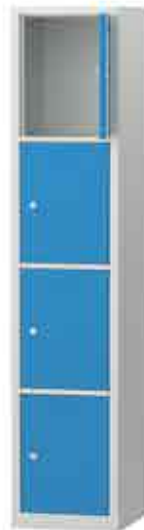

Code - 2264  
Locker Cabinet



Code - 2269  
File Cabinet

A large stack of blue plastic pallets in a warehouse setting. The pallets are arranged in tall, rectangular columns, with some individual pallets in the foreground showing their grid-like top surfaces. The lighting is bright, highlighting the texture and color of the plastic.

# *Plastic Pallets*

## Plastic Pallet



*Dynamic Load*



*Racking Load*



*Static Load*



## Plastic Pallet



Dimensions	Standard color	Weight ( kg )	Truck load	Static load (kg)	Dynamic (kg)
120cmX100cmx15cm	Green,Gray,Blue,Red,Yellow	22	Pcs 408	7000	2000
120cmX80cmx15cm	Green,Gray,Blue,Red,Yellow	12.5	Pcs 600	3000	900

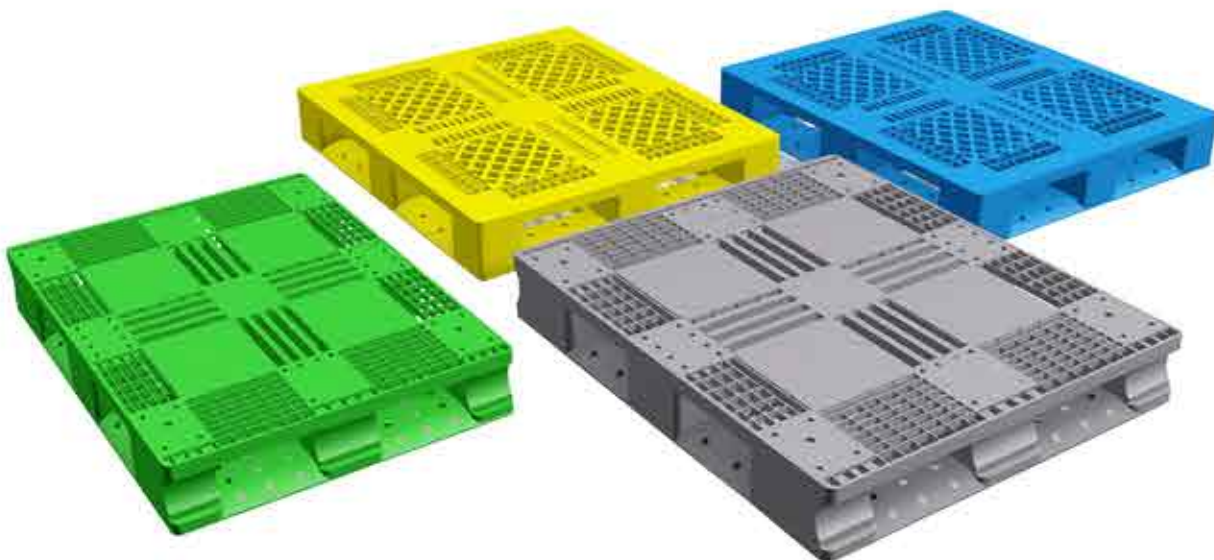



# *Wooden Pallets*



### Wooden Pallets

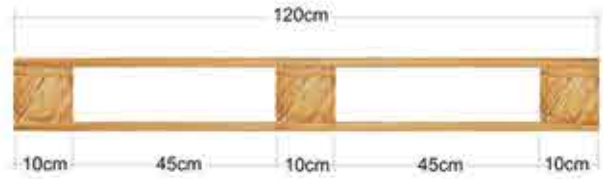
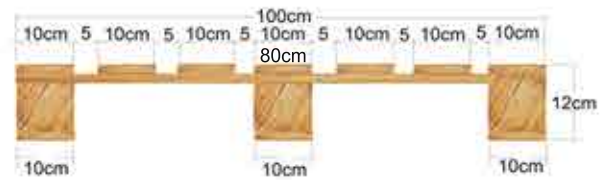
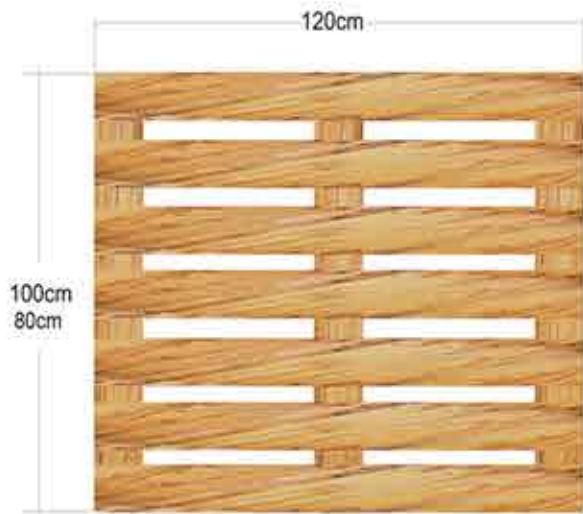

## Wooden Pallets



## Hand Pallet Specification

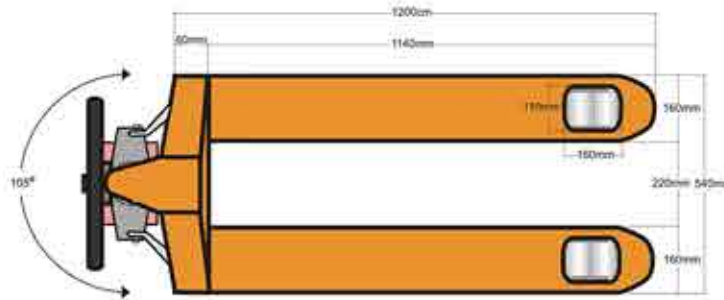

Top View

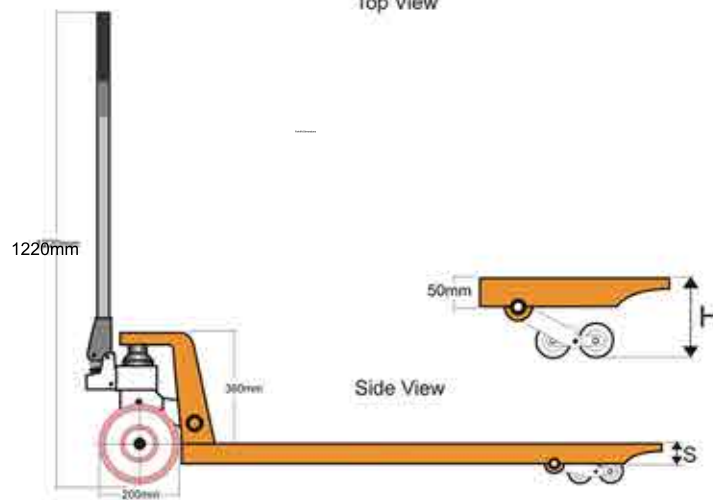

Side View

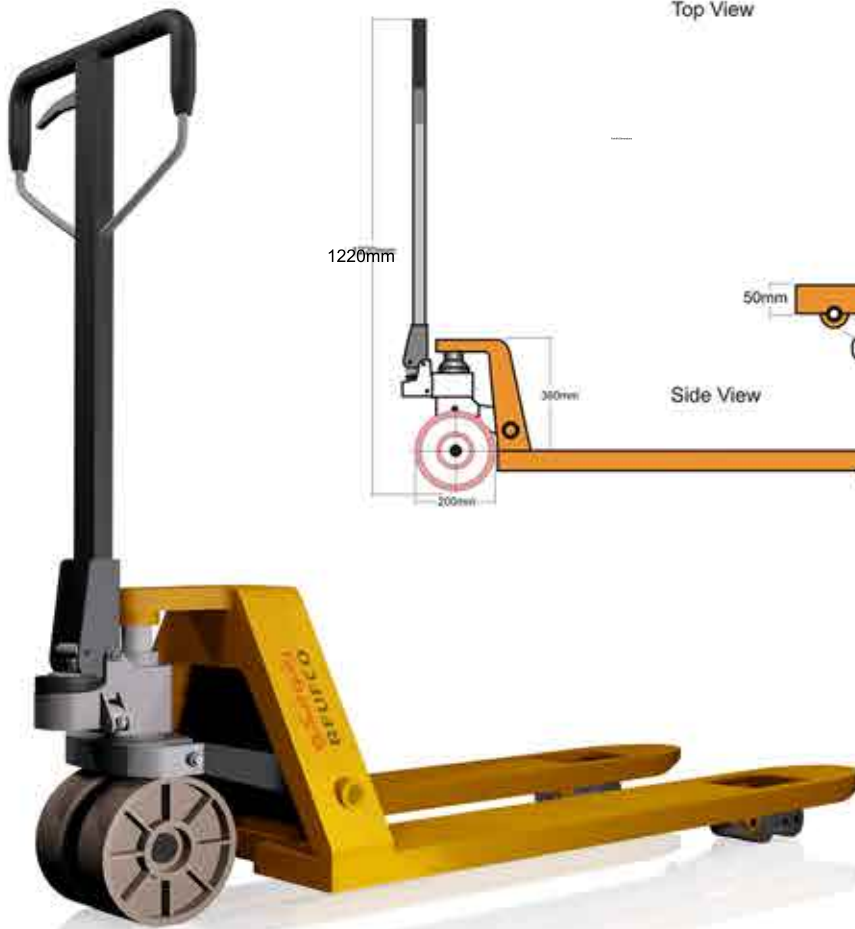

### Specifications:

Max.Capacity = 2,500kgs.  
 Lowered Fork Height = 85mm  
 Total Lift Height = 1220mm  
 Handle Less Height = 460mm  
 Fork Length = 1150mm  
 Overall Fork Width = 540mm

## Folding Steel Pallet Container



Step 1



Step 3



Step 2



Step 4



Steel Pallet



## Industrial Steel Ladder



*Heavy Duty Rolling Ladder*



*Light Duty multi-purpose Ladder*



*Standard Crossover Ladder*



*Cantiliver Ladder*

Industrial Steel Pallet Container



BO





*Push Cart Roll Container*



*Industrial Push Cart*



## Chrome Hanging & shelving system



*Chrome Hanging & Shelvings System*



## Chrome Hanging & Shelving System



*Some of Finish Project*



*Some of Finish Project*



*Some of Finish Project*





*Some of Finish Project*



*Some of Finish Project*



*Some of Finish Project*



*Some of Finish Project*



## *Interlock Racking Load Notice*



Conduct regular inspections to check for:

- Correct application and use;
- Loads within allowable safe limits;
- Accidental damage, or dislodgement of Structure Components.



**REPORT ALL DAMAGE TO  
THE RACKING SAFETY  
OFFICER**



Do not alter the structure without either:

- checking effects against
- manufacturing technical data,  
obtaining approval from supplier.



**DO NOT CLIMB  
PALLET RACKING**



Refer To SEMA  
'Code of Practice for the  
Use of Static Pallet Racking'



If in doubt  
**ALWAYS**  
Contact Supplier